

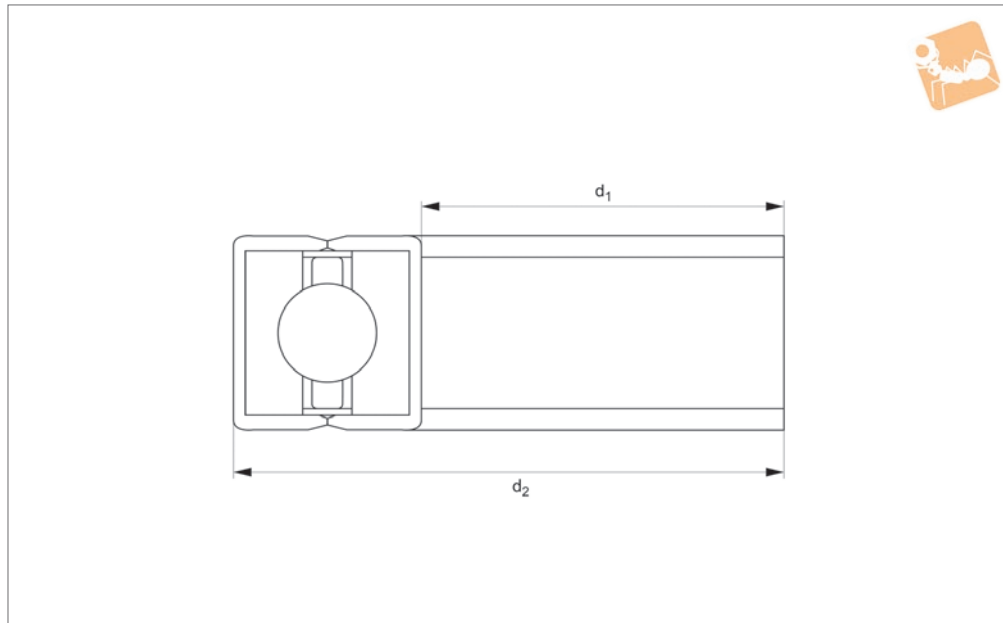

# Split Bearing - Slim

slim bearing type

## Ring Bearings



**R4205**

RING BEARINGS

### Material

Corrosion resistant split bearing rings.  
Ball bearings retained in plastic cage.

### Tips

Our split bearings are compatible with most other manufacturers and are very cost

competitive. Please ask us to 'cross reference' if required.

Order No.	d <sub>1</sub> & d <sub>3</sub> mm	d <sub>2</sub> mm	d <sub>4</sub> mm	Dyn. load C <sub>ax</sub> kN max.	Dyn. load C <sub>rad</sub> kN max.	Speed min. <sup>-1</sup> max.	Static load C <sub>0 ax</sub> kN max.	Static load C <sub>0 rad</sub> kN max.	Weight kg
R4205.070	175.0	199.65	199.5	10.4	9.4	870	57.6	23.0	0.32
R4205.075	187.7	212.35	212.20	10.5	9.5	810	61.2	24.8	0.34
R4205.080	200.4	225.05	224.9	10.8	9.8	760	65.7	26.1	0.36
R4205.085	213.1	237.75	237.6	11.0	10.0	720	69.3	27.9	0.38
R4205.090	225.8	250.45	250.3	11.3	10.2	680	73.8	29.3	0.41
R4205.095	238.5	263.15	263.0	11.5	10.4	640	78.3	31.5	0.43
R4205.100	251.2	275.85	275.7	11.7	10.6	610	81.9	32.9	0.45
R4205.105	263.9	288.55	288.4	12.0	10.8	580	86.4	34.7	0.47
R4205.110	276.6	301.25	301.1	12.2	11.0	550	90.0	36.0	0.50
R4205.115	289.3	313.95	313.8	12.3	11.2	530	94.5	37.8	0.52
R4205.120	302.0	326.65	326.5	12.5	11.3	510	98.1	39.2	0.54
R4205.130	327.4	352.05	351.9	12.9	11.6	470	106.2	42.3	0.59
R4205.140	352.8	377.45	377.3	13.2	12.0	430	114.3	45.9	0.63
R4205.150	378.2	402.85	402.7	13.6	12.2	400	122.4	48.6	0.68
R4205.160	403.6	428.25	428.1	13.9	12.5	380	130.5	52.2	0.72
R4205.170	429.0	453.65	453.5	14.1	12.8	360	138.6	55.8	0.77
R4205.180	454.4	479.05	478.9	14.5	13.0	340	146.7	58.5	0.81
R4205.190	479.8	504.45	504.3	14.8	13.3	320	154.8	62.1	0.86
R4205.200	505.2	529.85	529.7	15.0	13.6	300	162.9	64.8	0.90
R4205.210	530.6	555.25	555.1	15.3	13.9	290	171.0	68.4	0.95
R4205.220	556.0	580.65	580.5	15.6	14.0	270	179.1	71.1	0.99
R4205.230	581.4	606.05	605.9	15.8	14.3	260	187.2	74.7	1.04
R4205.240	606.8	631.45	631.3	16.1	14.5	250	195.3	78.3	1.08
R4205.250	632.2	656.85	656.7	16.3	14.8	240	203.4	81.0	1.13
R4205.260	657.6	682.25	682.1	16.6	14.9	230	211.5	84.6	1.17
R4205.270	683.0	707.65	707.5	16.8	15.2	220	220.5	88.2	1.22
R4205.280	708.4	733.05	732.9	17.0	15.4	220	229.50	90.9	1.26
R4205.290	733.8	758.45	758.3	17.2	15.6	210	234.0	94.5	1.31
R4205.300	759.2	783.85	783.7	17.4	15.8	200	243.0	97.2	1.35
R4205.310	784.6	809.25	809.1	17.6	15.9	190	252.0	100.8	1.40
R4205.320	810.0	834.65	834.5	17.8	16.1	190	261.0	104.4	1.44
R4205.330	835.4	860.05	859.9	18.0	16.3	180	270.0	107.1	1.49
R4205.340	863.6	885.45	885.3	18.3	18.5	180	274.5	110.7	1.53