

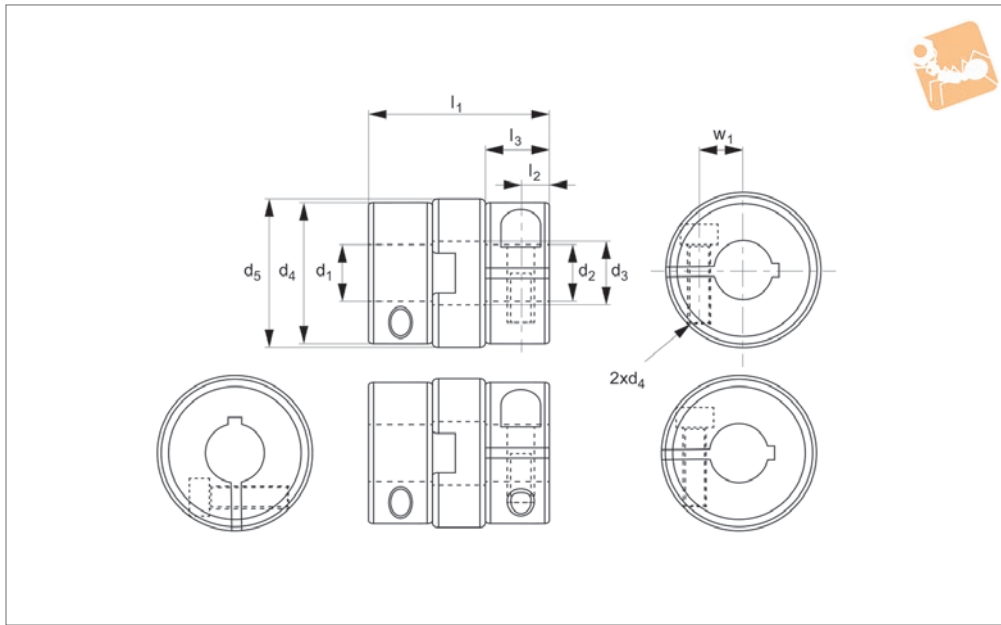

Oldham Couplings

stainless steel hub

Flexible Couplings

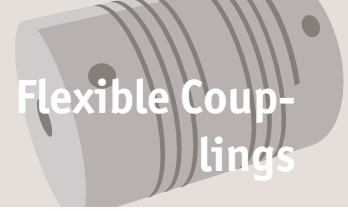

R3054

FLEXIBLE COUPLINGS

Material

Hub - stainless steel 1,4305.
Insert - polyurethane, bronze or nylon.

Technical Notes

Max. shaft to shaft misalignment 0,3mm.
Max. angular misalignment 1°.

Max. backlash 10 minutes.
For clamps see part no. R3250.

Order No.	Type	l	Ø B	Ø d	Ø H	Torque Ncm max.	Ø C	Centre material
CO3-4M-U	Pin	16.7	3.995	15.9	7.9	50	-	Polyur.
CO3-4M-B	Pin	16.7	3.995	15.9	7.9	250	-	Bronze
CO3-4M-N	Pin	16.7	3.995	15.9	7.9	75	-	Nylon
CO3-5M-U	Pin	18.3	4.995	15.9	9.5	50	-	Polyur.
CO3-5M-B	Pin	18.3	4.995	15.9	9.5	250	-	Bronze
CO3-5M-N	Pin	18.3	4.995	15.9	9.5	75	-	Nylon
CO3-6M-U	Pin	19.8	5.995	15.9	12.7	50	-	Polyur.
CO3-6M-B	Pin	19.8	5.995	15.9	12.7	250	-	Bronze
CO3-6M-N	Pin	19.8	5.995	15.9	12.7	75	-	Nylon
CO3-8M-U	Pin	19.8	7.995	15.9	12.7	50	-	Polyur.
CO3-8M-B	Pin	19.8	7.995	15.9	12.7	250	-	Bronze
CO3-8M-N	Pin	19.8	7.995	15.9	12.7	75	-	Nylon
CO3-10M-U	Pin	39.7	9.995	34.9	19.1	250	-	Polyur.
CO3-10M-N	Pin	39.7	9.995	34.9	19.1	360	-	Nylon
CO3-13M-U	Pin	46.0	12.995	38.1	25.4	300	-	Polyur.
CO3-13M-B	Pin	46.0	12.995	38.1	25.4	1225	-	Bronze
CO3-13M-N	Pin	46.0	12.995	38.1	25.4	430	-	Nylon
CO6-4M-U	Clamp	21.4	3.995	15.9	-	50	5.6	Polyur.
CO6-4M-B	Clamp	21.4	3.995	15.9	-	250	5.6	Bronze
CO6-4M-N	Clamp	21.4	3.995	15.9	-	75	5.6	Nylon
CO6-5M-U	Clamp	21.4	4.995	15.9	-	50	6.6	Polyur.
CO6-5M-B	Clamp	21.4	4.995	15.9	-	250	6.6	Bronze
CO6-5M-N	Clamp	21.4	4.995	15.9	-	75	6.6	Nylon
CO6-6M-U	Clamp	21.4	5.995	15.9	-	50	7.6	Polyur.
CO6-6M-B	Clamp	21.4	5.995	15.9	-	250	7.6	Bronze
CO6-6M-N	Clamp	21.4	5.995	15.9	-	75	7.6	Nylon