

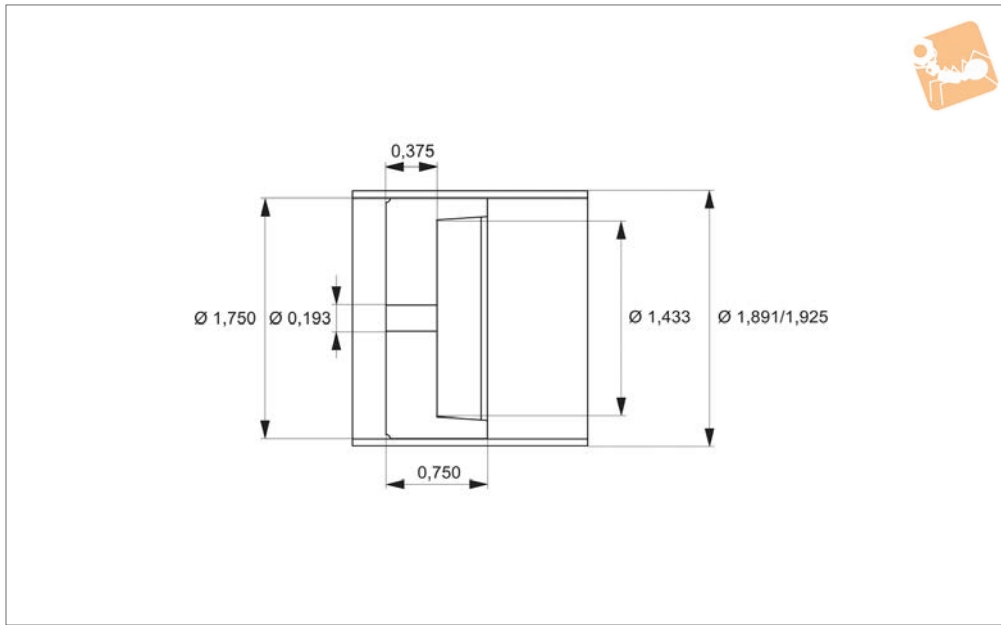

# Cylinder / Piston Set

1,750" bore

## Cylinders



**L4640**

CYLINDERS

### Material

Piston: Carbon graphite  
Cylinder: Glass

### Technical Notes

Max operating temp = 260°C

### Important Notes

Specials available on request.

Order No.	Stroke	Bore dia.	Outside dia.	Cylinder length	Piston length	Piston area in <sup>2</sup>	Friction W/O sideload g	Cylinder weight g	Piston weight g
L4640.0500	0,5"	1.750	1.925	1.350	0.750	2.406	< 1	18.56	34.60
L4640.1000	1,0"	1.750	1.925	1.850	0.750	2.406	< 1	18.56	34.60
L4640.2000	2,0"	1.750	1.925	2.850	0.750	2.406	< 1	18.56	34.60
L4640.3000	3,0"	1.750	1.925	3.850	0.750	2.406	< 1	18.56	34.60
L4640.4000	4,0"	1.750	1.925	4.850	0.750	2.406	< 1	18.56	34.60
L4640.5000	5,0"	1.750	1.925	5.850	0.750	2.406	< 1	18.56	34.60
L4640.6000	6,0"	1.750	1.925	6.850	0.750	2.406	< 1	18.56	34.60
L4640.7000	7,0"	1.750	1.925	7.850	0.750	2.406	< 1	18.56	34.60
L4640.8000	8,0"	1.750	1.925	8.850	0.750	2.406	< 1	18.56	34.60