

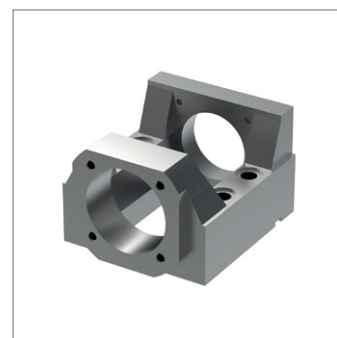

Motor Bracket (MBA) for ball & lead screws

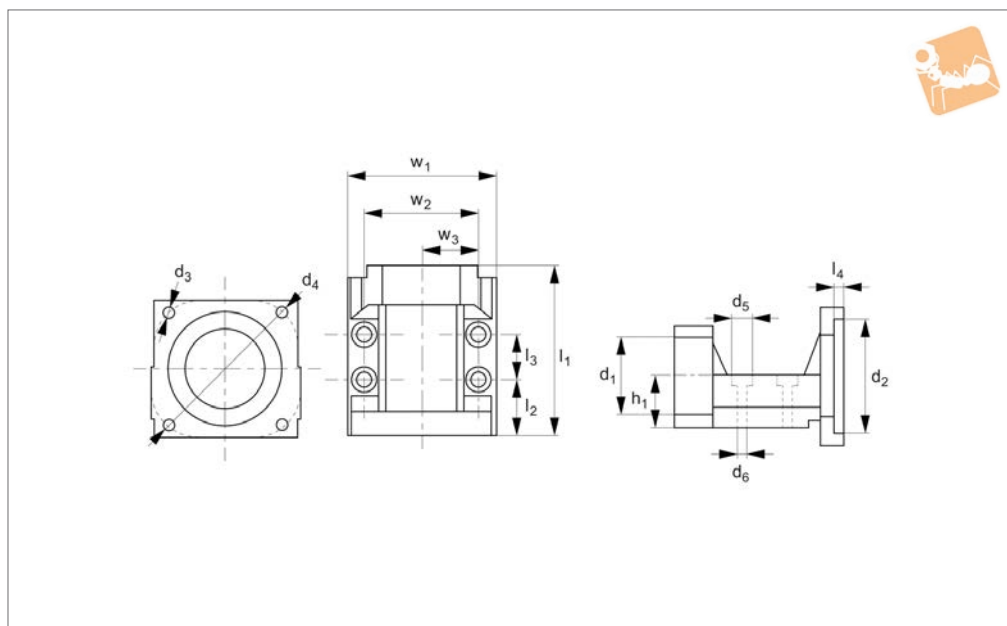
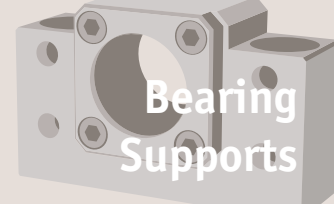

L1408

BEARING SUPPORTS

Material

Steel with black oxide finish.

This provides a quick and easy solution to combine a motor with the fixed bearing unit.

Technical Notes

Parallelism between the two faces is 0.02.

Order No.	d ₁ tol. H7	d ₂ tol. H7	d ₃	d ₄	d ₅	d ₆	h ₁ ±0.02	l ₁	l ₂	l ₃	l ₄	w ₁	w ₂	w ₃	Compatible support unit
L1408.MBA06A	28	30.0	M3	45.0	9.5	5.5	17	61	19	20	4	52	41	26.0	L1400.FKA06
L1408.MBA08A	28	30.0	M4	46.0	9.5	5.5	17	61	19	20	4	52	41	26.0	L1400.FKA08
L1408.MBA10A	34	30.0	M3	45.0	11.0	6.6	22	74	24	20	4	65	50	32.5	L1390.FK10
L1408.MBA10B	34	30.0	M4	46.0	11.0	6.6	22	74	24	20	4	65	50	32.5	L1390.FK10
L1408.MBA10C	34	38.1	M4	66.7	11.0	6.6	22	74	24	20	4	65	50	32.5	L1390.FK10
L1408.MBA10D	34	50.0	M5	70.0	11.0	6.6	22	74	24	20	4	65	50	32.5	L1390.FK10
L1408.MBA10E	34	50.0	M4	70.0	11.0	6.6	22	74	24	20	4	65	50	32.5	L1390.FK10
L1408.MBA12A	36	30.0	M3	45.0	11.0	6.6	25	74	24	20	4	65	50	32.5	L1390.FK12
L1408.MBA12B	36	30.0	M4	46.0	11.0	6.6	25	74	24	20	4	65	50	32.5	L1390.FK12
L1408.MBA12C	36	38.1	M4	66.7	11.0	6.6	25	74	24	20	4	65	50	32.5	L1390.FK12
L1408.MBA12D	36	50.0	M5	70.0	11.0	6.6	25	74	24	20	4	65	50	32.5	L1390.FK12
L1408.MBA12E	36	50.0	M4	70.0	11.0	6.6	25	74	24	20	4	65	50	32.5	L1390.FK12
L1408.MBA15A	40	38.1	M4	66.7	11.0	6.6	28	82	24	28	4	70	55	35.0	L1390.FK15
L1408.MBA15B	40	50.0	M5	70.0	14.0	6.6	28	82	24	28	4	70	55	35.0	L1390.FK15
L1408.MBA15C	40	50.0	M4	70.0	14.0	6.6	28	82	24	28	4	70	55	35.0	L1390.FK15
L1408.MBA15D	40	73.0	M6	98.4	14.0	8.5	28	92	29	28	6	88	70	44.0	L1390.FK15
L1408.MBA15E	40	70.0	M6	90.0	14.0	8.5	28	92	29	28	6	88	70	44.0	L1390.FK15
L1408.MBA15F	40	70.0	M5	90.0	14.0	8.5	28	92	29	42	6	88	70	44.0	L1390.FK15
L1408.MBA20A	57	50.0	M5	70.0	14.0	8.5	34	113	29	42	4	88	70	44.0	L1400.FKA20
L1408.MBA20B	57	50.0	M4	70.0	14.0	8.5	34	113	29	42	4	88	70	44.0	L1400.FKA20
L1408.MBA20C	57	73.0	M6	98.4	14.0	8.5	34	113	29	42	6	88	70	44.0	L1400.FKA20
L1408.MBA20D	57	70.0	M6	90.0	14.0	8.5	34	113	29	42	6	88	70	44.0	L1400.FKA20
L1408.MBA20E	57	70.0	M5	90.0	14.0	8.5	34	113	29	42	6	88	70	44.0	L1400.FKA20

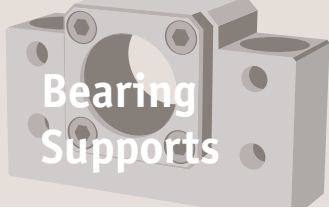

Notes

When inserting the screw shaft to the support unit, take care not to let the oil seal lip turn upward.

When securing the set piece with a hexagonal socket head set screw, apply an adhesive to the hexagonal socket head set screw before tightening it in order to prevent the screw from loosening. If planning to use the product in a harsh environment, it is also necessary to take measures to prevent other components/parts from loosening. Contact our Technical Department for details.

Installing the support unit

1. Install the fixed side support unit to the screw shaft.
2. After inserting the fixed side support unit, secure the lock nut using the fastening set piece and the hexagonal socket head set screw.
3. Attach the support side bearing to the screw shaft and secure the bearing using the snap ring, and then install the assembly to the housing on the supported side.

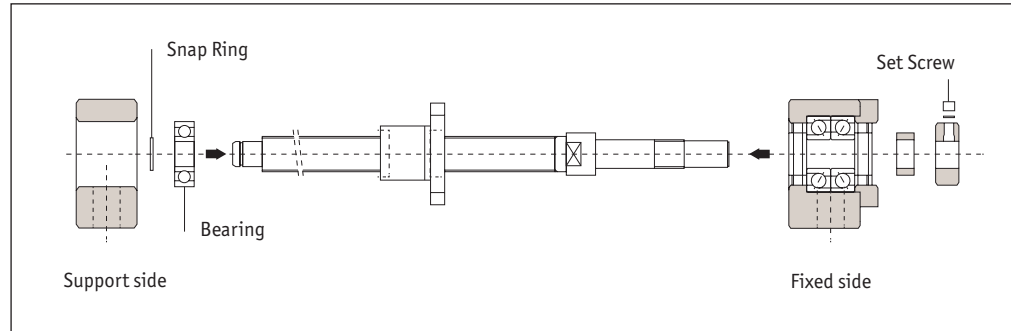

Installation onto the table and the base

1. If using a bracket when mounting the ball screw nut to the carriage, insert the nut into the bracket and temporarily fasten it.
2. Temporarily fasten the fixed side support unit to the base. In doing so, press the table toward the fixed side support unit to align the axial centre, and adjust the carriage so that it can travel freely.
3. Press the carriage toward the fixed side support unit to align the axial centre. Make the adjustment by reciprocating the table several times so that the nut travels slowly over the whole stroke, and temporarily secure the support unit to the base.

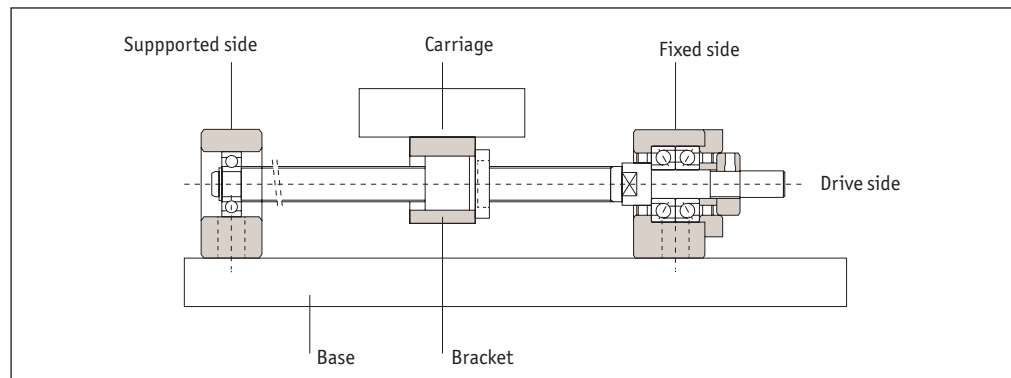

Checking the accuracy and fully fastening the support unit

1. While checking the runout of the ball screw shaft end and the axial clearance using a dial gauge, fully fasten the ball screw nut, the nut bracket, the fixed side support unit and the support side unit, in this order.

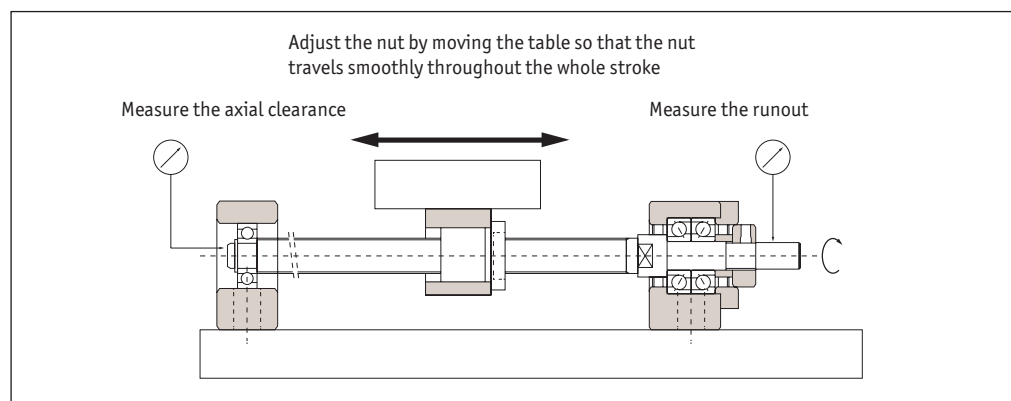



Technical Information

Bearing supports units assembly



Connection with motor

1. Mount motor bracket to the base.
2. Connect the motor and the ball screw using a coupling (make sure the mounting accuracy is maintained).
3. Mount motor bracket to the base.

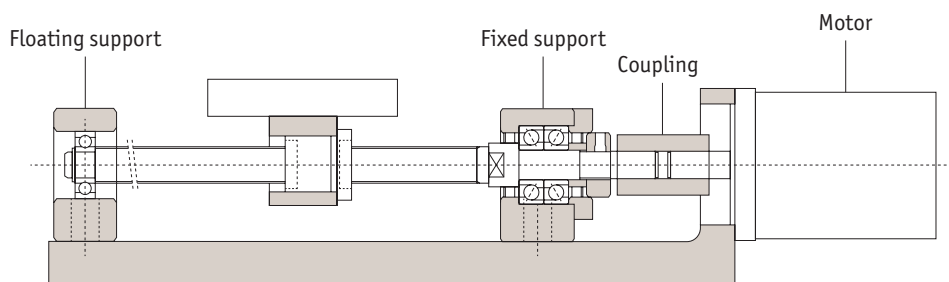

The fixed support unit is always positioned at the end where the motor/handwheel is.

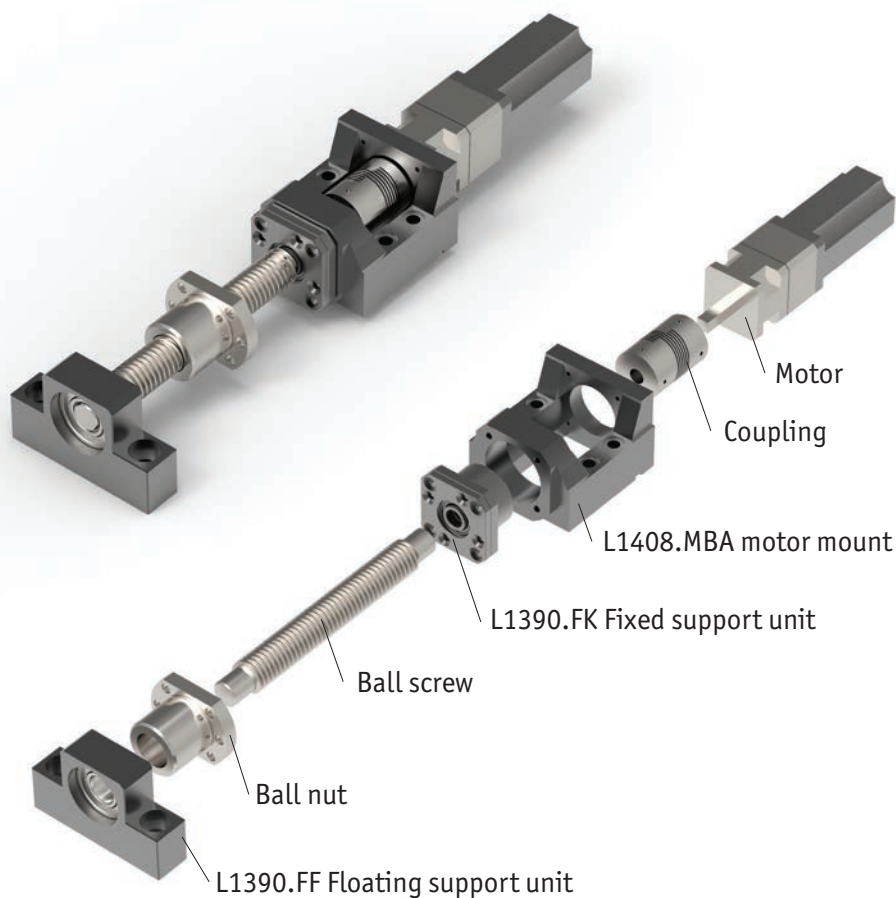

Bearing Supports from Automation Components

BEARING SUPPORTS



Technical Information

Fixed side for unit types; FK, EK, AK, FKA and LK

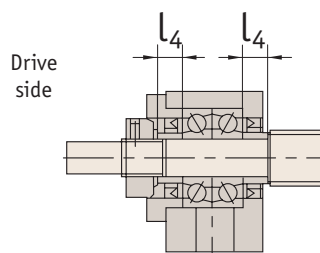
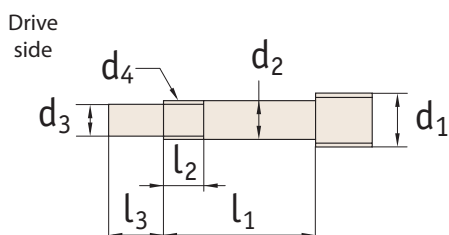
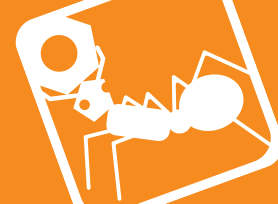

All Other Types

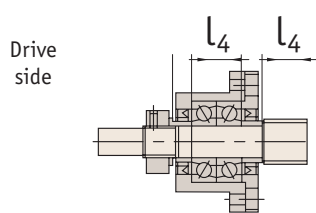

Type L1390.FK (Option 1)
L1400.FKA

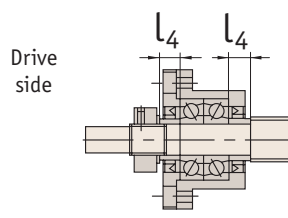

Type L1390.FK (Option 2)
L1400.FKA

Part no.					Thread ø	Shaft support ø					For thread		
FK	EK	AK	FKA	LK	d ₁	d ₂		h ₇	l ₁	l ₃	d ₄	l ₂	l ₄
L1390.FK05	L1394.EK05	-	-	-	8	5	-0,008 -0,015	4	23	6	M5x0,5	7	3,5
L1390.FK06	L1394.EK06	-	-	-	8	6	-0,008 -0,015	4	28	8	M6x0,75	8	5,0
L1390.FK08	L1394.EK08	-	L1400.FKA08	L1402.LK08	10/12	8	-0,008 -0,015	6	32	9	M8x1,0	10	5,5
L1390.FK10	L1394.EK10	L1388.AK10	L1400.FKA10	L1402.LK08	12/14/15	10	-0,008 -0,015	8	35	15	M10x1,0	12	5,5
L1390.FK12	L1394.EK12	L1388.AK12	L1400.FKA12	L1402.LK08	14/15/16	12	-0,008 -0,015	10	35	15	M12x1,0	12	5,5
L1390.FK15	L1394.EK15	L1388.AK15	L1400.FKA15	L1402.LK08	18/20	15	-0,008 -0,017	12	48	20	M15x1,0	13	10,0
L1390.FK17	-	-	-	-	20/25	17	-0,008 -0,017	15	59	23	M17x1,0	17	10,0
L1390.FK20	L1394.EK20	L1388.AK20	L1400.FKA20	-	25/28/30	20	-0,008 -0,017	17	63	25	M20x1,0	15	11,0
L1390.FK25	-	-	-	-	30/32/36	25	-0,008 -0,017	20	76	30	M25x1,5	20	14,0
L1390.FK30	-	-	-	-	36/40	30	-0,008 -0,018	25	73	38	M30x1,5	25	9,0



Technical Information

Fixed side for unit type L1392.BK

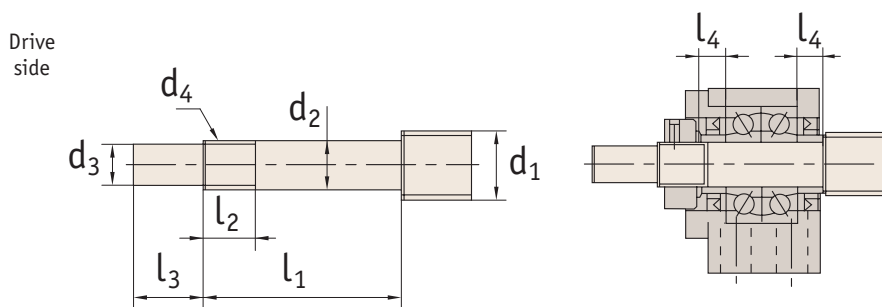

Part sno.	Thread ϕ	Shaft support ϕ					Thread		
BK	d_1	d_2		d_3	l_1	l_3	d_4	l_2	l_4
L1392.BK10	12/14/15	10	-0,008 -0,015	8	36	15	M10x1,0	12	5,5
L1392.BK12	14/15/16	12	-0,008 -0,015	10	36	15	M12x1,0	12	5,5
L1392.BK15	18/20	15	-0,008 -0,017	12	40	20	M15x1,0	12	6,0
L1392.BK17	20/25	17	-0,008 -0,017	15	53	23	M17x1,0	17	7,0
L1392.BK20	25/28	20	-0,008 -0,017	17	53	25	M20x1,0	15	8,0
L1392.BK25	32/36	25	-0,008 -0,017	20	66	30	M25x1,5	20	9,0
L1392.BK30	36/40	30	-0,008 -0,018	25	73	38	M30x1,5	25	9,0
L1392.BK35	45	35	-0,008 -0,018	30	82	45	M35x1,5	26	12,0
L1392.BK40	50	40	-0,008 -0,018	35	94	50	M40x1,5	30	15,0