



Steel Knurled Thumb Screws

Steel (class 5.8) - zinc-plated



Thumb Screws

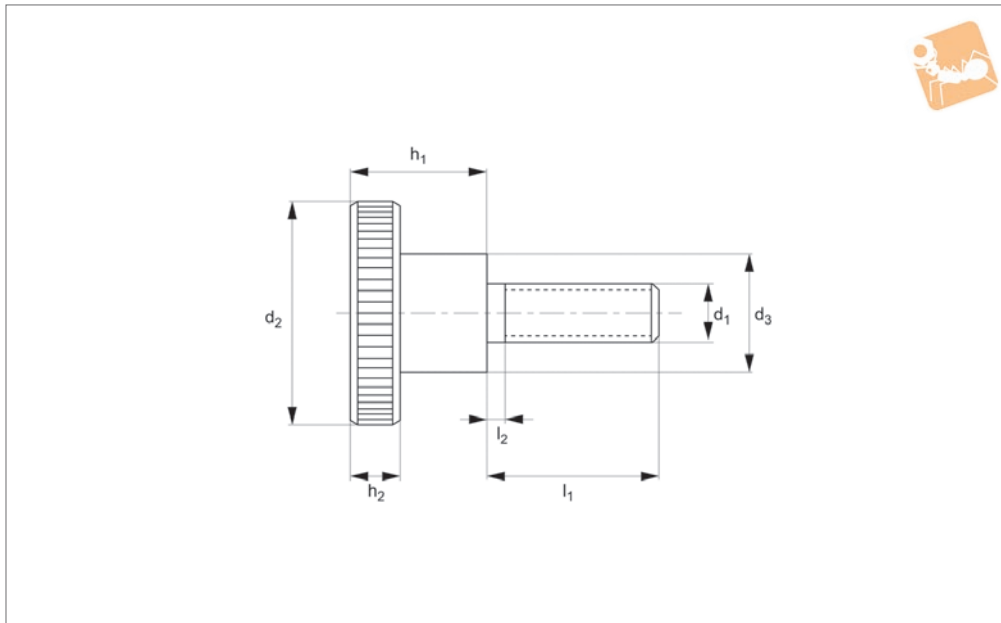

P0400.ZP

THUMB SCREWS

Material

Steel (class 5.8), bright zinc-plated.

Technical Notes

To DIN 464, all knurled screws are one-

piece manufactured, contrary to the official standard sheet, they all have a thread up to the head, as shown, but no recess at the thread end.

Order No.	d ₁	l ₁	d ₂	d ₃	h ₁	h ₂	l ₂
P0400.030-006-ZP	M 3	6	12	6	7.5	2.5	2
P0400.030-010-ZP	M 3	10	12	6	7.5	2.5	2
P0400.030-012-ZP	M 3	12	12	6	7.5	2.5	2
P0400.030-016-ZP	M 3	16	12	6	7.5	2.5	2
P0400.030-020-ZP	M 3	20	12	6	7.5	2.5	2
P0400.040-006-ZP	M 4	6	16	8	9.5	3.5	2
P0400.040-008-ZP	M 4	8	16	8	9.5	3.5	2
P0400.040-010-ZP	M 4	10	16	8	9.5	3.5	2
P0400.040-012-ZP	M 4	12	16	8	9.5	3.5	2
P0400.040-016-ZP	M 4	16	16	8	9.5	3.5	2
P0400.040-020-ZP	M 4	20	16	8	9.5	3.5	2
P0400.040-025-ZP	M 4	25	16	8	9.5	3.5	2
P0400.050-006-ZP	M 5	6	20	10	11.5	4.0	2
P0400.050-008-ZP	M 5	8	20	10	11.5	4.0	2
P0400.050-010-ZP	M 5	10	20	10	11.5	4.0	2
P0400.050-012-ZP	M 5	12	20	10	11.5	4.0	2
P0400.050-016-ZP	M 5	16	20	10	11.5	4.0	2
P0400.050-020-ZP	M 5	20	20	10	11.5	4.0	2
P0400.050-025-ZP	M 5	25	20	10	11.5	4.0	2
P0400.050-030-ZP	M 5	30	20	10	11.5	4.0	2
P0400.060-008-ZP	M 6	8	24	12	15.0	5.0	2
P0400.060-010-ZP	M 6	10	24	12	15.0	5.0	2
P0400.060-012-ZP	M 6	12	24	12	15.0	5.0	2
P0400.060-016-ZP	M 6	16	24	12	15.0	5.0	2
P0400.060-020-ZP	M 6	20	24	12	15.0	5.0	2
P0400.060-025-ZP	M 6	25	24	12	15.0	5.0	2
P0400.060-030-ZP	M 6	30	24	12	15.0	5.0	2
P0400.060-035-ZP	M 6	35	24	12	15.0	5.0	2
P0400.060-040-ZP	M 6	40	24	12	15.0	5.0	2
P0400.080-012-ZP	M 8	12	30	16	18.0	6.0	2
P0400.080-016-ZP	M 8	16	30	16	18.0	6.0	2
P0400.080-020-ZP	M 8	20	30	16	18.0	6.0	2
P0400.080-025-ZP	M 8	25	30	16	18.0	6.0	2
P0400.080-030-ZP	M 8	30	30	16	18.0	6.0	2



Order No.	d ₁	l ₁	d ₂	d ₃	h ₁	h ₂	l ₂
P0400.080-035-ZP	M 8	35	30	16	18.0	6.0	2
P0400.080-040-ZP	M 8	40	30	16	18.0	6.0	2
P0400.100-020-ZP	M10	20	36	20	23.0	8.0	2
P0400.100-025-ZP	M10	25	36	20	23.0	8.0	2
P0400.100-030-ZP	M10	30	36	20	23.0	8.0	2
P0400.100-035-ZP	M10	35	36	20	23.0	8.0	2
P0400.100-040-ZP	M10	40	36	20	23.0	8.0	2



Knurled Thumb Screws

DIN 464



Thumb Screws

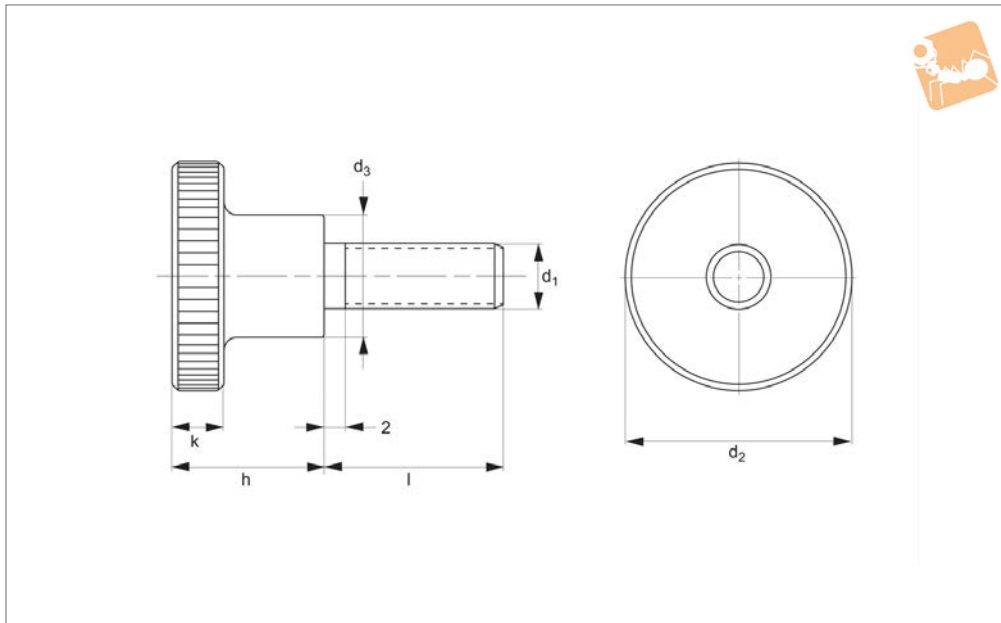

P0400.BL

THUMB SCREWS

Material

Steel, quality 5.8, blackened. Turned, visible face, good finish.

Contra-ry to the Official Standard Sheet, they all have a thread up to the head, as shown, but no recess at the thread end.

Technical Notes

All knurled screws are one-piece manufac-

Order No.	d ₁	d ₂	d ₃	h	k	l	Weight g
P0400.030-006-BL	M 3	12	6	7.5	2.5	6	3.7
P0400.030-010-BL	M 3	12	6	7.5	2.5	10	3.8
P0400.030-012-BL	M 3	12	6	7.5	2.5	12	4.0
P0400.030-016-BL	M 3	12	6	7.5	2.5	16	4.0
P0400.040-008-BL	M 4	16	8	9.5	3.5	8	7.9
P0400.040-010-BL	M 4	16	8	9.5	3.5	10	8.1
P0400.040-012-BL	M 4	16	8	9.5	3.5	12	8.3
P0400.040-016-BL	M 4	16	8	9.5	3.5	16	8.4
P0400.040-020-BL	M 4	16	8	9.5	3.5	20	9.1
P0400.040-025-BL	M 4	16	8	9.5	3.5	25	9.0
P0400.050-006-BL	M 5	20	10	11.5	4.0	6	14.0
P0400.050-008-BL	M 5	20	10	11.5	4.0	8	15.0
P0400.050-010-BL	M 5	20	10	11.5	4.0	10	15.0
P0400.050-012-BL	M 5	20	10	11.5	4.0	12	15.0
P0400.050-020-BL	M 5	20	10	11.5	4.0	20	16.0
P0400.050-025-BL	M 5	20	10	11.5	4.0	25	17.0
P0400.050-030-BL	M 5	20	10	11.5	4.0	30	17.0
P0400.060-008-BL	M 6	24	12	15.0	5.0	8	28.0
P0400.060-010-BL	M 6	24	12	15.0	5.0	10	27.0
P0400.060-012-BL	M 6	24	12	15.0	5.0	12	28.0
P0400.060-016-BL	M 6	24	12	15.0	5.0	16	28.0
P0400.060-020-BL	M 6	24	12	15.0	5.0	20	29.0
P0400.060-025-BL	M 6	24	12	15.0	5.0	25	30.0
P0400.060-030-BL	M 6	24	12	15.0	5.0	30	31.0
P0400.060-035-BL	M 6	24	12	15.0	5.0	35	31.0
P0400.080-012-BL	M 8	30	16	18.0	6.0	12	53.0
P0400.080-016-BL	M 8	30	16	18.0	6.0	16	55.0
P0400.080-020-BL	M 8	30	16	18.0	6.0	20	56.0
P0400.080-025-BL	M 8	30	16	18.0	6.0	25	58.0
P0400.080-030-BL	M 8	30	16	18.0	6.0	30	60.0
P0400.080-035-BL	M 8	30	16	18.0	6.0	35	50.0
P0400.080-040-BL	M 8	30	16	18.0	6.0	40	61.0



Order No.	d ₁	d ₂	d ₃	h	k	l	Weight g
P0400.100-020-BL	M10	36	20	23.0	8.0	20	106.0
P0400.100-025-BL	M10	36	20	23.0	8.0	25	109.0
P0400.100-030-BL	M10	36	20	23.0	8.0	30	112.0
P0400.100-035-BL	M10	36	20	23.0	8.0	35	116.0
P0400.100-040-BL	M10	36	20	23.0	8.0	40	116.0