

## Available materials

- CC	Chrome steel AISI 52100 Balls. Machined AISI 1016 steel housing, toughened & zinc plated
Solve specific application requirements by upgrading materials. Select option by adding suffix i.e. - CS	
- CS	Stainless Steel Balls (AISI 420) but other materials as Standard. Reduce load by 30%.
- SS	All parts in Stainless Steel - out housing AISI 416, Balls AISI 420. Reduce load by 30%.
- CD	Acetal (POM) main ball option - reduce load. See chart overleaf

## Fixing clip selection

Part No.	Ball Size	Minimum Bore $\phi$	Maximum Bore $\phi$
P2730.015	15	24,8	25,0
P2730.022	22	37,0	37,2
P2730.030	30	46,3	46,7

Clip requires a minimum plate thickness of 3mm to grip securely

## How to select the correct unit

Ball Type	Max Load (Kg)	Friction (% of load)	Speed m/sec	Shock Loads		Arduous Conditions	Orientation	Instant Change
				✓✓✓	✓✓			
Medium Duty	20-3500	2%	1,5	✓✓✓	✓✓	✓✓		✓✓✓
Light Duty	7-250	3%	1,0	✓		✓✓		✓✓✓

## Variables to consider:



### Shock Loads:

Standard material ball units have Rockwell 'C' hardness of 60 minimum



### Track Hardness/Conveyed Item Material:

Standard material ball units have Rockwell 'C' hardness of 60 minimum



### Delicate Surfaces:

Ball Units - Acetal (POM) & Phenolic Resin



### Operating Environment:

Wet, dirty, outdoor, radioactive



**P2760**

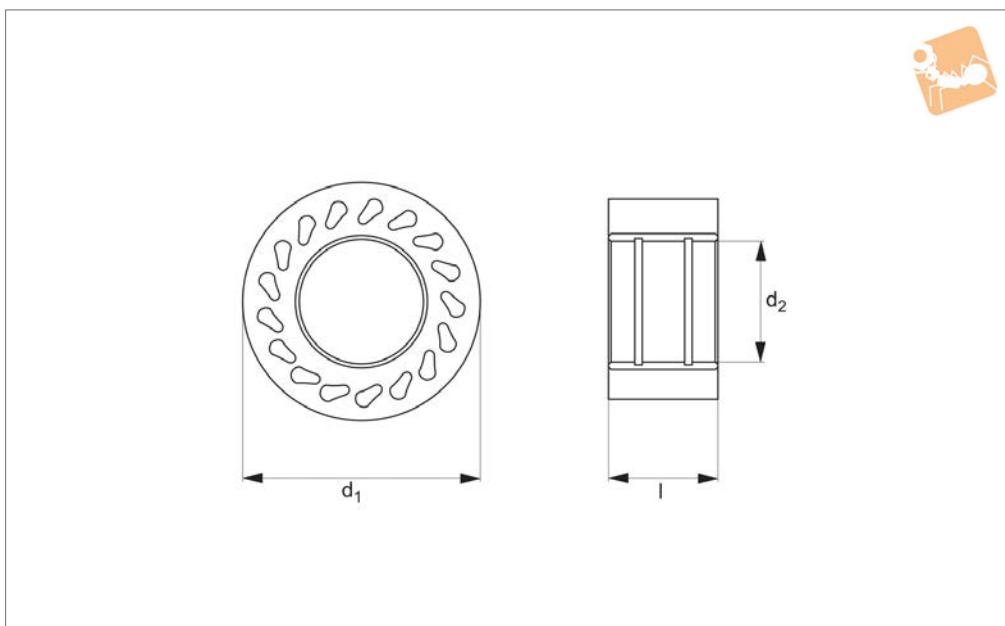

**Material**

Urethane bonded to a steel insert. Hardness from 35-95 durometer (Shore A).

**Tips**

Durasoft rollers have „teardrop“ holes to allow the roller to flex for firm but non-damaging contact.

**Technical Notes**

Roller only - allows for custom mounting.

Order No.	Durometer	d <sub>1</sub>	l	d <sub>2</sub> min.   max.
P2760.25A60	60	63,5 (2,5")	23.37	28,58/28,65
P2760.25B60	60	63,5 (2,5")	49.28	31,80/31,90
P2760.40A60	60	101,6 (4")	23.37	31,80/31,90
P2760.40B60	60	101,6 (4")	49.28	31,80/31,90



# Durasoft Roller stud mount

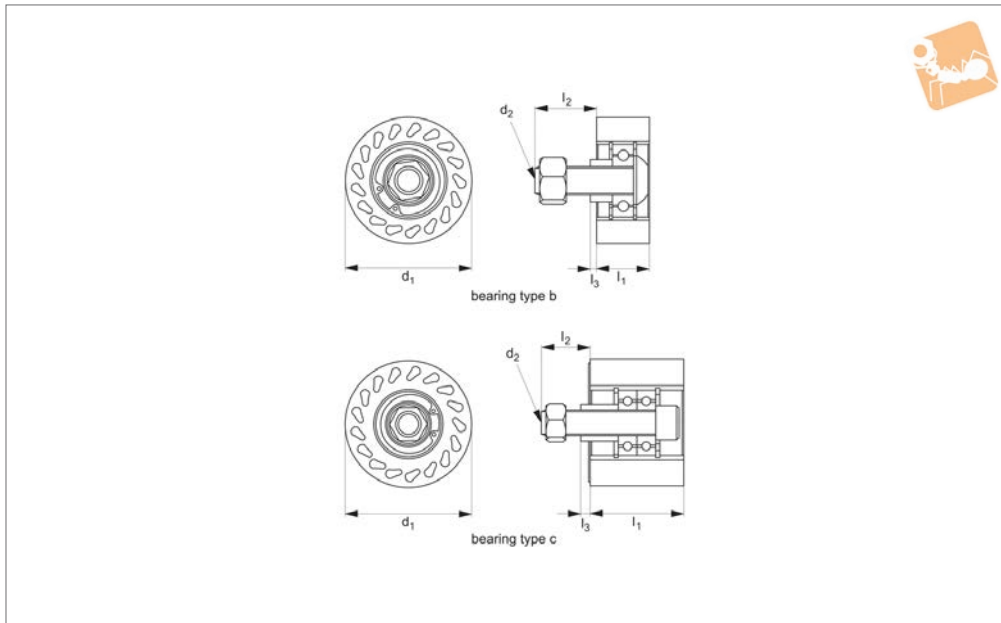

**P2764**

MATERIAL HANDLING

### Material

Urethane bonded to a steel insert. Hardness from 35-80 durometer (Shore A).

For more details on bearings please see technical pages. Assembled with socket head cap screw, spacer and lock nut.

allow the roller to flex for firm but non-damaging contact.

### Technical Notes

Bearings included (held in place with snap

### Tips

Durasoft rollers have „teardrop“ holes to

Order No.	Durometer	d <sub>1</sub>	l <sub>1</sub>	d <sub>2</sub>	l <sub>2</sub>	l <sub>3</sub>	Bearing type
P2764.25B35	35	62,5 (2,5")	23.37	1/2-13	27.94	3.05	B
P2764.25B60	60	62,5 (2,5")	23.37	1/2-13	27.94	3.05	B
P2764.25B80	80	62,5 (2,5")	23.37	1/2-13	27.94	3.05	B
P2764.25C35	35	62,5 (2,5")	49.28	1/2-13	35.81	6.35	C
P2764.25C60	60	62,5 (2,5")	49.28	1/2-13	35.81	6.35	C
P2764.25C80	80	62,5 (2,5")	49.28	1/2-13	35.81	6.35	C
P2764.40A35	35	101,6 (4")	23.37	1/2-13	27.94	3.05	B
P2764.40A60	60	101,6 (4")	23.37	1/2-13	27.94	3.05	B
P2764.40A80	80	101,6 (4")	23.37	1/2-13	27.94	3.05	B
P2764.40B35	35	101,6 (4")	49.28	1/2-13	35.81	6.35	C
P2764.40B60	60	101,6 (4")	49.28	1/2-13	35.81	6.35	C
P2764.40B80	80	101,6 (4")	49.28	1/2-13	35.81	6.35	C



**P2766**

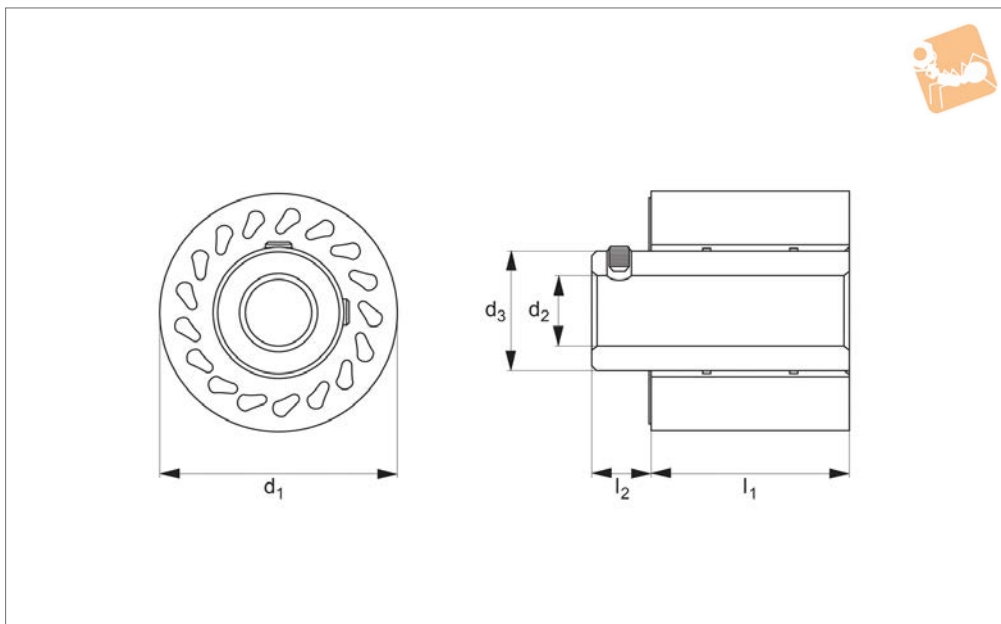

**Material**

Urethane bonded to a steel insert. Hardness from 35-80 durometer (Shore A).

**Technical Notes**

Designed to be mounted onto a shaft. A

hub extends past the roller and is supplied with two set screws at 90°.

**Tips**

Durasoft rollers have „teardrop” holes to allow the roller to flex for firm but non-

damaging contact.

Order No.	Durometer	d <sub>1</sub>	l <sub>1</sub>	d <sub>2</sub> min.   max.	l <sub>2</sub>	d <sub>3</sub>
P2766.25A60	60	63,5 (2,5")	23.37	12,73/12,83	12.7	31.75



# Durasoft Roller clutch bearing

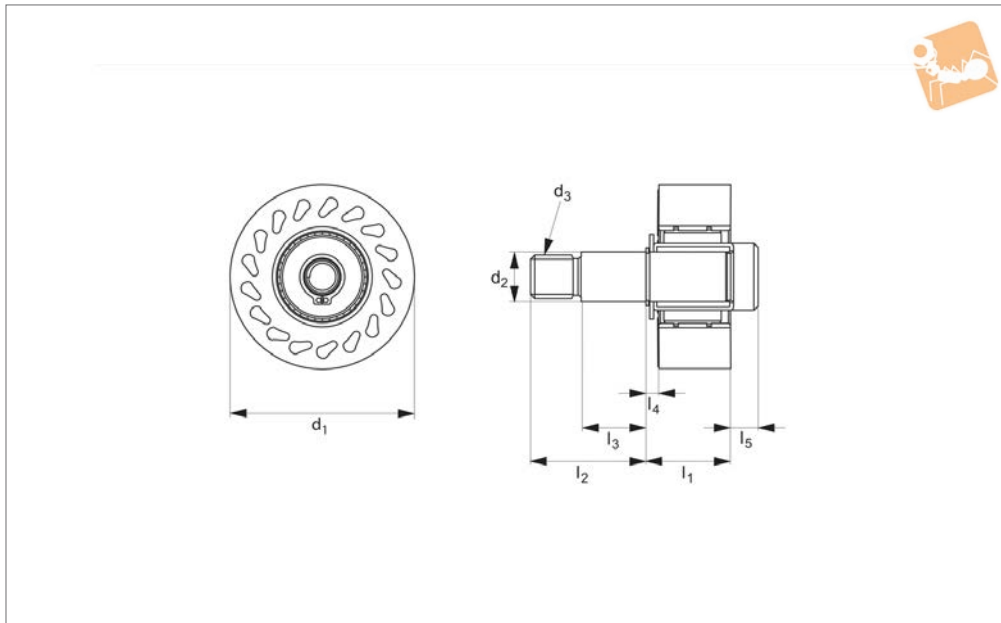

**P2768**

MATERIAL HANDLING

### Material

Urethane bonded to a steel insert. Hardness from 35-80 durometer (Shore A).

### Technical Notes

A clutch bearing allows the roller to turn in only one direction. Available in left or right

hand rotation (with the stud pointed upwards, a right hand rotation turns clockwise).

Type R= right hand clutch bearing.

Type L= left hand clutch bearing.

### Tips

Durasoft rollers have „teardrop“ holes to allow the roller to flex for firm but non-damaging contact. All clutch bearing are type I. Please see technical page for more information on the bearing.

Order No.	Type	Durometer	d <sub>1</sub>	l <sub>1</sub>	d <sub>2</sub> min./max.	l <sub>2</sub>	d <sub>3</sub>	l <sub>3</sub>	l <sub>4</sub>	l <sub>5</sub>
P2768.25A35-R	R	35	63,50 (2,5")	23.37	15,77/15,82	45.47	1/2-13"	26.42	3.05	10.41
P2768.25A60-R	R	60	63,50 (2,5")	23.37	15,77/15,82	45.47	1/2-13"	26.42	3.05	10.41
P2768.25A80-R	R	80	63,50 (2,5")	23.37	15,77/15,82	45.47	1/2-13"	26.42	3.05	10.41
P2768.25A35-L	L	35	63,50 (2,5")	23.37	15,77/15,82	45.47	1/2-13"	26.42	3.05	10.41
P2768.25A60-L	L	60	63,50 (2,5")	23.37	15,77/15,82	45.47	1/2-13"	26.42	3.05	10.41
P2768.25A80-L	L	80	63,50 (2,5")	23.37	15,77/15,82	45.47	1/2-13"	26.42	3.05	10.41
P2768.25B35-R	R	35	63,50 (2,5")	49.28	15,77/15,82	31.75	1/2-13"	12.70	10.92	-
P2768-25B60	R	60	63,50 (2,5")	49.28	15,77/15,82	31.75	1/2-13"	12.70	10.92	-
P2768.25B80-R	R	80	63,50 (2,5")	49.28	15,77/15,82	31.75	1/2-13"	12.70	10.92	-
P2768.25B35-L	L	35	63,50 (2,5")	49.28	15,77/15,82	31.75	1/2-13"	12.70	10.92	-
P2768.25B60-L	L	60	63,50 (2,5")	49.28	15,77/15,82	31.75	1/2-13"	12.70	10.92	-
P2768.25B80-L	L	80	63,50 (2,5")	49.28	15,77/15,82	31.75	1/2-13"	12.70	10.92	-
P2768.40A35-R	R	35	101,60 (4")	23.37	15,77/15,82	45.47	1/2-13"	26.42	3.05	10.41
P2768.40A60-R	R	60	101,60 (4")	23.37	15,77/15,82	45.47	1/2-13"	26.42	3.05	10.41
P2768.40A80-R	R	80	101,60 (4")	23.37	15,77/15,82	45.47	1/2-13"	26.42	3.05	10.41
P2768.40A35-L	L	35	101,60 (4")	23.37	15,77/15,82	45.47	1/2-13"	26.42	3.05	10.41
P2768.40A60-L	L	60	101,60 (4")	23.37	15,77/15,82	45.47	1/2-13"	26.42	3.05	10.41
P2768.40A80-L	L	80	101,60 (4")	23.37	15,77/15,82	45.47	1/2-13"	26.42	3.05	10.41
P2768.40B35-R	R	35	101,60 (4")	49.28	15,77/15,82	31.75	1/2-13"	12.70	10.92	-
P2768.40B60-R	R	60	101,60 (4")	49.28	15,77/15,82	31.75	1/2-13"	12.70	10.92	-
P2768.40B80-R	R	80	101,60 (4")	49.28	15,77/15,82	31.75	1/2-13"	12.70	10.92	-
P2768.40B35-L	L	35	101,60 (4")	49.28	15,77/15,82	31.75	1/2-13"	12.70	10.92	-
P2768.40B60-L	L	60	101,60 (4")	49.28	15,77/15,82	31.75	1/2-13"	12.70	10.92	-
P2768.40B80-L	L	80	101,60 (4")	49.28	15,77/15,82	31.75	1/2-13"	12.70	10.92	-



## Load & Stability

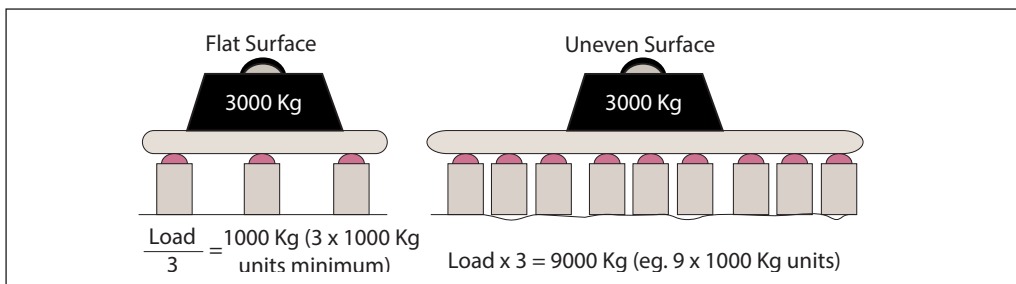

## Pitch & Spacing

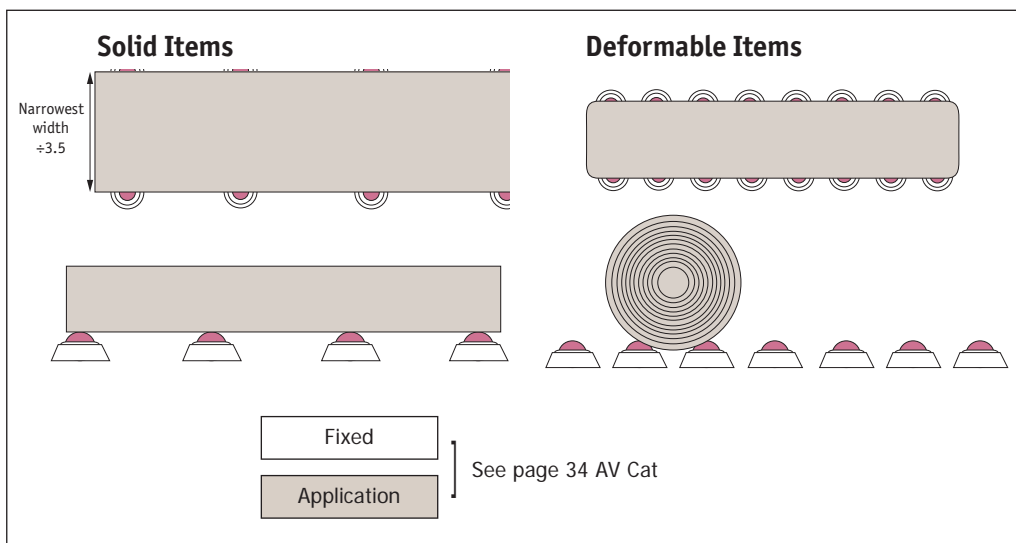

## Operating Temperature

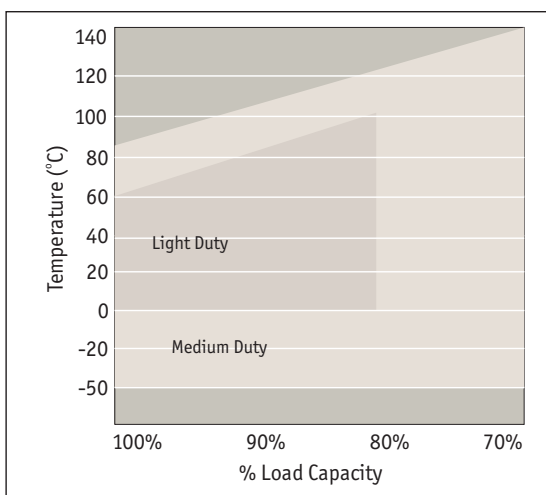

Ball Transfer Units from Automation Components

MATERIAL HANDLING