

# Open Linear Ball Bushing Carriages

unflanged

Linear Shaft  
Supports

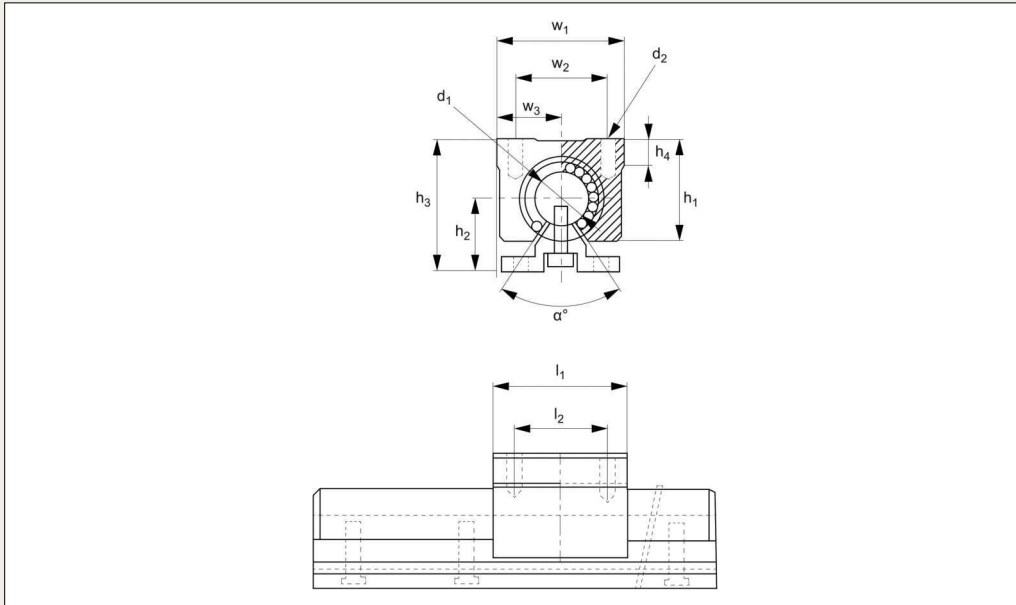

## L1752

### Material

Aluminium body, with L1707 (steel shell ) linear bearing installed. Bearing has a resin retainer (POM). Supplied with nitrile rubber (NBR) end seals -UU as standard.

### Technical notes

For use with hardened shafts only - see part no.s L1770 - L1772. Temperature range: -20°C to +80°C.

### Tips

Use with shaft support rail L1780. Particularly effective for high loads and long stroke applications.

### Important notes

**If using the carriage inverted, ie hanging loads, then the load rating is reduced by 50%.**

Order No.	d <sub>1</sub> tol. H6	l <sub>1</sub>	d <sub>2</sub>	l <sub>2</sub> ±0,2	w <sub>1</sub>	w <sub>2</sub> ±0,2	w <sub>3</sub>	h <sub>1</sub>	h <sub>2</sub>	h <sub>3</sub> ±0,05	h <sub>4</sub>	α°	Max. dyn. load C N	Max. static load C <sub>0</sub> N	⚖ g
L1752.016	16	45	M 5x12	30	45	32	22,5	33	26	46	9	80°	770	1170	150
L1752.020	20	50	M 6x12	35	48	35	24,0	39	32	55	11	60°	860	1370	200
L1752.025	25	65	M 6x12	40	60	40	30,0	47	36	62	14	50°	980	1560	450
L1752.030	30	70	M 8x18	50	70	50	35,0	56	42	75	15	50°	1560	2740	630
L1752.040	40	90	M10x20	65	90	65	45,0	72	50	92	20	50°	2150	4010	1330
L1752.050	50	110	M10x20	80	120	94	60,0	91	60	113	25	50°	3820	7930	3000