

Cylindrical Bronze Nuts

for lead screws

Lead Screws & Nuts

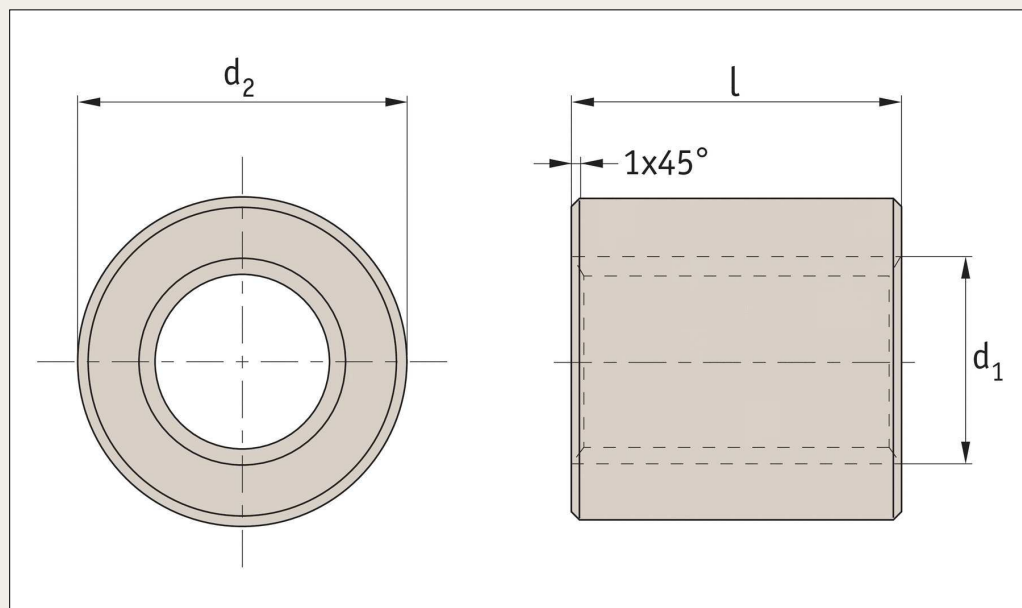

L1330

Material

Bronze (CuSn7ZnPb). To ISO 2901/2903 and DIN 103.

For manual or powered applications at low and medium rotation and under loads.

Standard nuts are right hand thread, single starts.

For use with steel or stainless steel lead screws, L1320, L1321, L1322, and L1323.

Technical notes

Tips

| Order No. | Size | d_1 7H | Lead | Thread direction | d_2 h10 | l | No. of starts | Contact surface mm ² | Δ± Kg |
|--------------|---------|-------------|------|------------------|--------------|-----|---------------|------------------------------------|----------|
| L1330.R10-02 | TR10x 2 | 10 | 2 | Right | 22 | 20 | 1 | 200 | 0,053 |
| L1330.R10-04 | TR10x 4 | 10 | 4 | Right | 22 | 20 | 2 | 200 | 0,053 |
| L1330.R12-03 | TR12x 3 | 12 | 3 | Right | 26 | 24 | 1 | 280 | 0,083 |
| L1330.R12-06 | TR12x 6 | 12 | 6 | Right | 26 | 24 | 2 | 280 | 0,083 |
| L1330.R14-03 | TR14x 3 | 14 | 3 | Right | 30 | 28 | 1 | 380 | 0,135 |
| L1330.R14-06 | TR14x 6 | 14 | 6 | Right | 30 | 28 | 2 | 380 | 0,135 |
| L1330.R16-04 | TR16x 4 | 16 | 4 | Right | 36 | 32 | 1 | 490 | 0,232 |
| L1330.R16-08 | TR16x 8 | 16 | 8 | Right | 36 | 32 | 2 | 490 | 0,232 |
| L1330.R18-04 | TR18x 4 | 18 | 4 | Right | 40 | 36 | 1 | 630 | 0,320 |
| L1330.R18-08 | TR18x 8 | 18 | 8 | Right | 40 | 36 | 2 | 630 | 0,320 |
| L1330.R20-04 | TR20x 4 | 20 | 4 | Right | 45 | 40 | 1 | 790 | 0,455 |
| L1330.R20-08 | TR20x 8 | 20 | 8 | Right | 45 | 40 | 2 | 790 | 0,455 |
| L1330.R22-05 | TR22x 5 | 22 | 5 | Right | 45 | 44 | 1 | 940 | 0,480 |
| L1330.R22-10 | TR22x10 | 22 | 10 | Right | 45 | 44 | 2 | 940 | 0,480 |
| L1330.R24-05 | TR24x 5 | 24 | 5 | Right | 50 | 48 | 1 | 1130 | 0,656 |
| L1330.R24-10 | TR24x10 | 24 | 10 | Right | 50 | 48 | 2 | 1130 | 0,656 |
| L1330.R26-05 | TR26x 5 | 26 | 5 | Right | 50 | 52 | 1 | 1340 | 0,670 |
| L1330.R26-10 | TR26x10 | 26 | 10 | Right | 50 | 52 | 2 | 1340 | 0,670 |
| L1330.R28-05 | TR28x 5 | 28 | 5 | Right | 60 | 56 | 1 | 2400 | 1,102 |
| L1330.R28-10 | TR28x10 | 28 | 10 | Right | 60 | 56 | 2 | 1570 | 1,102 |
| L1330.R30-06 | TR30x 6 | 30 | 6 | Right | 60 | 60 | 1 | 1780 | 1,140 |
| L1330.R30-12 | TR30x12 | 30 | 12 | Right | 60 | 60 | 2 | 1780 | 1,140 |
| L1330.R32-06 | TR32x 6 | 32 | 6 | Right | 60 | 64 | 1 | 1910 | 1,177 |
| L1330.R32-12 | TR32x12 | 32 | 12 | Right | 60 | 64 | 2 | 1910 | 1,177 |
| L1330.R36-06 | TR36x 6 | 36 | 6 | Right | 75 | 72 | 1 | 2610 | 2,189 |
| L1330.R36-12 | TR36x12 | 36 | 12 | Right | 75 | 72 | 2 | 2610 | 2,189 |
| L1330.R40-07 | TR40x 7 | 40 | 7 | Right | 80 | 80 | 1 | 3210 | 2,725 |
| L1330.R40-14 | TR40x14 | 40 | 14 | Right | 80 | 80 | 2 | 3210 | 2,725 |
| L1330.R44-07 | TR44x 7 | 44 | 7 | Right | 80 | 88 | 1 | 3920 | 2,815 |
| L1330.R50-08 | TR50x 8 | 50 | 8 | Right | 90 | 100 | 1 | 5060 | 4,014 |
| L1330.R60-09 | TR60x 9 | 60 | 9 | Right | 100 | 120 | 1 | 7320 | 5,150 |

Cylindrical Bronze Nuts

for lead screws

Lead Screws & Nuts

| Order No. | Size | d ₁ 7H | Lead | Thread direction | d ₂ h10 | l | No. of starts | Contact surface mm ² | Δ± Kg |
|---------------------|---------|----------------------|------|------------------|-----------------------|-----|---------------|------------------------------------|----------|
| L1330.R70-10 | TR70x10 | 70 | 10 | Right | 110 | 140 | 1 | 10000 | 7,805 |
| L1330.R80-10 | TR80x10 | 80 | 10 | Right | 120 | 160 | 1 | 12950 | 9,800 |
| L1330.L10-02 | TR10x 2 | 10 | 2 | Left | 22 | 20 | 1 | 200 | 0,053 |
| L1330.L12-03 | TR12x 3 | 12 | 3 | Left | 26 | 24 | 1 | 280 | 0,083 |
| L1330.L14-03 | TR14x 3 | 14 | 3 | Left | 30 | 28 | 1 | 380 | 0,136 |
| L1330.L16-04 | TR16x 4 | 16 | 4 | Left | 36 | 32 | 1 | 490 | 0,232 |
| L1330.L18-04 | TR18x 4 | 18 | 4 | Left | 40 | 36 | 1 | 630 | 0,320 |
| L1330.L20-04 | TR20x 4 | 20 | 4 | Left | 45 | 40 | 1 | 790 | 0,455 |
| L1330.L22-05 | TR22x 5 | 22 | 5 | Left | 45 | 44 | 1 | 940 | 0,480 |
| L1330.L24-05 | TR24x 5 | 24 | 5 | Left | 50 | 48 | 1 | 1130 | 0,656 |
| L1330.L26-05 | TR26x 5 | 26 | 5 | Left | 50 | 52 | 1 | 1340 | 0,670 |
| L1330.L28-05 | TR28x 5 | 28 | 5 | Left | 60 | 56 | 1 | 2400 | 1,102 |
| L1330.L30-06 | TR30x 6 | 30 | 6 | Left | 60 | 60 | 1 | 1780 | 1,140 |
| L1330.L32-06 | TR32x 6 | 32 | 6 | Left | 60 | 64 | 1 | 1910 | 1,177 |
| L1330.L36-06 | TR36x 6 | 36 | 6 | Left | 75 | 72 | 1 | 2610 | 2,189 |
| L1330.L40-07 | TR40x 7 | 40 | 7 | Left | 80 | 80 | 1 | 3210 | 2,725 |
| L1330.L44-07 | TR44x 7 | 44 | 7 | Left | 80 | 88 | 1 | 3920 | 2,815 |
| L1330.L50-08 | TR50x 8 | 50 | 8 | Left | 90 | 100 | 1 | 5060 | 4,014 |
| L1330.L60-09 | TR60x 9 | 60 | 9 | Left | 100 | 120 | 1 | 7320 | 5,150 |
| L1330.L70-10 | TR70x10 | 70 | 10 | Left | 110 | 140 | 1 | 10000 | 7,805 |
| L1330.L80-10 | TR80x10 | 80 | 10 | Left | 120 | 160 | 1 | 12950 | 9,800 |