

Aircraft Cable -stainless steel

Material:
DIN 1.4300

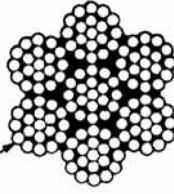

R1090



Material
Stainless steel DIN 1,4300.

Order No.	Diameter	Type	Construction	Length	Tensile strength N (min.)	Jacket Ø
AB018-7,5	0,4	Plain	7x7	7,5	178	-
AB018-15	0,4	Plain	7x7	15	178	-
AB018-30	0,4	Plain	7x7	30	178	-
AB032-7,5	0,8	Plain	7x7	7,5	534	-
AB032-15	0,8	Plain	7x7	15	534	-
AB032-30	0,8	Plain	7x7	30	534	-
AB033-7,5	0,8	Plain	7x19	7,5	534	-
AB033-15	0,8	Plain	7x19	15	534	-
AB033-30	0,8	Plain	7x19	30	534	-
AB046-7,5	1,2	Plain	7x7	7,5	1201	-
AB046N-7,5	1,2	Nylon coat	7x7	7,5	1201	1,6
AB046-15	1,2	Plain	7x7	15	1201	-
AB046N-15	1,2	Nylon coat	7x7	15	1201	1,6
AB046-30	1,2	Plain	7x7	30	1201	-
AB046N-30	1,2	Nylon coat	7x7	30	1201	1,6
AB062-7,5	3,2	Plain	7x19	7,5	2491	-
AB062N-7,5	3,2	Nylon coat	7x7	7,5	2491	3,2
AB062-15	3,2	Plain	7x19	15	2491	-
AB062N-15	3,2	Nylon coat	7x7	15	2491	3,2
AB062-30	3,2	Plain	7x19	30	2491	-
AB062N-30	3,2	Nylon coat	7x7	30	2491	3,2
AB078-7,5	2,0	Plain	7x19	7,5	2491	-
AB078-15	2,0	Plain	7x19	15	2491	-
AB078-30	2,0	Plain	7x19	30	2491	-
AB092-7,5	2,4	Plain	7x19	7,5	4270	-
AB092N-7,5	2,4	Nylon coat	7x7	7,5	4270	4,8
AB092-15	2,4	Plain	7x19	15	4270	-
AB092N-15	2,4	Nylon coat	7x7	15	4270	4,8
AB092-30	2,4	Plain	7x19	30	4270	-
AB092N-30	2,4	Nylon coat	7x7	30	4270	4,8
AB0125-7,5	3,2	Plain	7x19	7,5	7829	-
AB0125N-7,5	3,2	Nylon coat	7x19	7,5	7829	4,8
AB0125-15	3,2	Plain	7x19	15	7829	-
AB0125N-15	3,2	Nylon coat	7x19	15	7829	4,8
AB0125-30	3,2	Plain	7x19	30	7829	-
AB0125N-30	3,2	Nylon coat	7x19	30	7829	4,8
AB0156-7,5	4,0	Plain	7x19	7,5	10676	-
AB0156-15	4,0	Plain	7x19	15	10676	-
AB0156-30	4,0	Plain	7x19	30	10676	-



DRIVE CHAINS & SPROCKETS

linear and rotary motion components
Automation

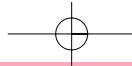

R1055-80 Flex-e-Pitch - Field Splice Kits

for chain series 14CCF, 25CCF, 35CCF and 7CCF

DRIVE CHAINS & SPROCKETS

Order No.	Description
14CCF-7	Complete kit (crimp tool, pitch spacer, sample chain cable cutter, bushings, razor blades and instructions). For 14CCF, 25CCF, 35CCF and 7CCF chain.
25CCF-7	As above.
35CCF-7	As above.
7CCF-7	As above.
TL-3	Crimp tool for 14CCF, 25CCF, 35CCF.
TL-8	Crimp block for 7CCF.
BU-032-S	Extra splice bushings for 14CCF and 25CCF (0,8 cable).
BU-046-S	Extra splice bushings for 35CCF (1,2 cable).
BU-062-L	Extra splice bushings for 7CCF (1,6 cable).
TL-1	Cable cutter for up to 1,2 cable.
TL-2	Cable cutter for 7CCF (1,6 cable).
TL-9	7CCF Pitch space fixture.

Splicing Procedures

1. Cut Min-e-Pitch sharp and square using cutter TL-1, to desired number of pitches, plus one pitch.

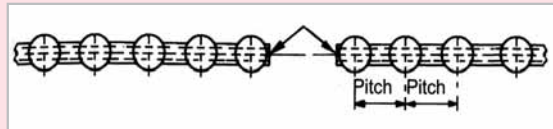

2. Cut plastic jacket (one pitch each side) lightly with a sharp razor blade (all around).

Caution: do not cut or fray cable. Strip or twist off jacket carefully.

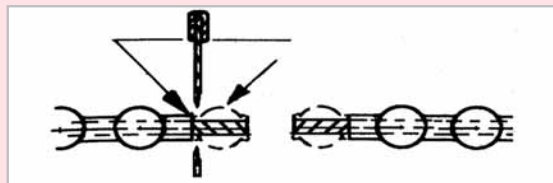

3. Slide stripped cable into oval splice bushing carefully.

Caution: Do not fray cable. Feed cable into chamfered end of bushing last.

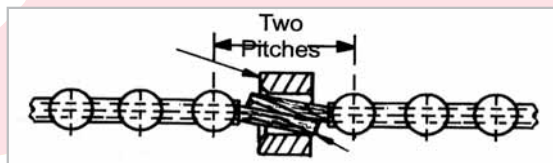

4. Centre bushing and be certain chain or belt is straight.

5. Position crimp tool over bushing and squeeze tightly for maximum splice strength.

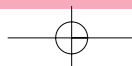
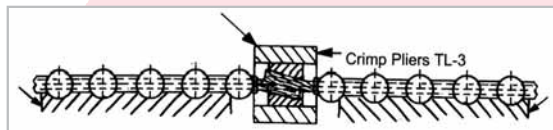

Cable Thimbles

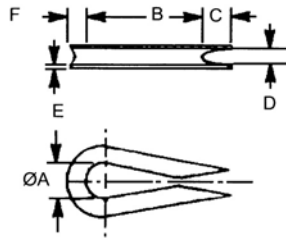

R1098



Material
Stainless steel.



DRIVE CHAINS & SPROCKETS

Order No.	Cable Ø's	A Ø	B	C	D	E	F
TH-032-S	0,4-1,0	4,8	6	3	3	0,4	1
TH-062-S	1,0-2,0	9,0	17	5	2	0,8	2
TH-092-S	2,4-3,0	9,0	18	6	4	0,8	2
TH-0156-S	4,0	10,2	20	6	4	0,8	3
TH-0187-S	5,0	12,7	25	8	5	0,8	4

Cable Crimp Bushings

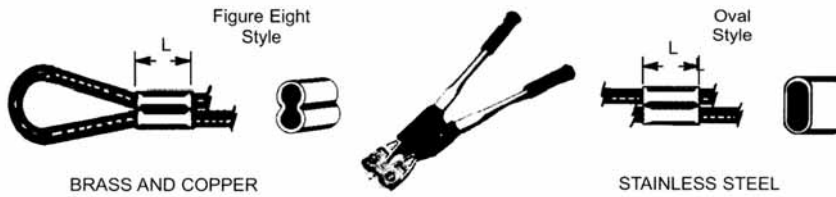

R1099



Material
Copper (zinc plated), brass or stainless steel.

Technical Notes

* BU093C can be used for 2,0Ø cable.

Order No.	Material	Length L	Cable Ø	Crimp tool no.
BU-018-B	Brass	6,4	0,4	TL-10
BU-032-C	Copper	7,0	0,8	TL-10
BU-046-C	Copper	11,0	1,0	TL-10
BU-062-C	Copper	6,4	1,6	TL-10
BU-093-C	Copper	12,7	2,0 & 2,4	TL-11
BU-0125-C	Copper	19,0	3,0	TL-11
BU-0156-C	Copper	22,2	4,0	TL-11
BU-0187-C	Copper	31,8	5,0	TL-11
BU-018-S	Stainless	0,8	0,4	TL-4
BU-032-S	Stainless	1,2	0,8	TL-3
BU-046-S	Stainless	3,2	1,0	TL-3
BU-062-S	Stainless	4,8	1,6	TL-7
BU-078-S	Stainless	6,4	2,0	TL-6

