



P1043



Material

Steel, blackened. Quality 5.8.

Technical Notes

All knurled screws are one piece manufactured. Contrary to the official standards sheet they all have a thread up to the head, as shown, but no recess at the thread end.

Knurled Thumb Screws

steel

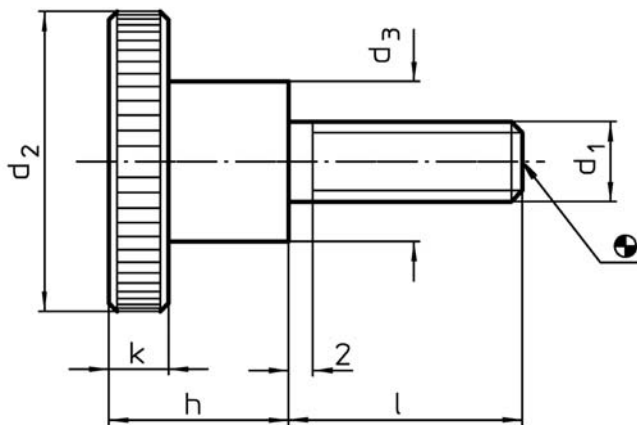

Order No.	d ₁	l	d ₂	d ₃	h	k	$\frac{\Delta}{g}$
P1043.03-06	M3	6	12	6	7,5	2,5	3,5
P1043.03-10	M3	10	12	6	7,5	2,5	3,7
P1043.03-12	M3	12	12	6	7,5	2,5	3,8
P1043.03-16	M3	16	12	6	7,5	2,5	4,2
P1043.04-05	M4	5	16	8	9,5	3,5	8,2
P1043.04-08	M4	8	16	8	9,5	3,5	8,6
P1043.04-10	M4	10	16	8	9,5	3,5	8,6
P1043.04-12	M4	12	16	8	9,5	3,5	8,8
P1043.04-16	M4	16	16	8	9,5	3,5	9,1
P1043.04-20	M4	20	16	8	9,5	3,5	9,6
P1043.04-25	M4	25	16	8	9,5	3,5	10,0
P1043.05-06	M5	6	20	10	11,5	4,0	15,2
P1043.05-08	M5	8	20	10	11,5	4,0	15,4
P1043.05-10	M5	10	20	10	11,5	4,0	15,7
P1043.05-12	M5	12	20	10	11,5	4,0	16,0
P1043.05-16	M5	16	20	10	11,5	4,0	16,7
P1043.05-20	M5	20	20	10	11,5	4,0	17,0
P1043.05-25	M5	25	20	10	11,5	4,0	18,0
P1043.05-30	M5	30	20	10	11,5	4,0	18,6
P1043.06-08	M6	8	24	12	15,0	5,0	26,0
P1043.06-10	M6	10	24	12	15,0	5,0	27,0
P1043.06-12	M6	12	24	12	15,0	5,0	28,0
P1043.06-16	M6	16	24	12	15,0	5,0	29,0
P1043.06-20	M6	20	24	12	15,0	5,0	30,0
P1043.06-25	M6	25	24	12	15,0	5,0	31,0
P1043.06-30	M6	30	24	12	15,0	5,0	32,0
P1043.06-35	M6	35	24	12	15,0	5,0	33,0
P1043.08-12	M8	12	30	16	18,0	6,0	55,0
P1043.08-16	M8	16	30	16	18,0	6,0	56,0
P1043.08-20	M8	20	30	16	18,0	6,0	60,0
P1043.08-25	M8	25	30	16	18,0	6,0	61,0
P1043.08-30	M8	30	30	16	18,0	6,0	62,0
P1043.08-35	M8	35	30	16	18,0	6,0	63,0
P1043.08-40	M8	40	30	16	18,0	6,0	64,0
P1043.10-20	M10	20	36	20	23,0	8,0	108,0
P1043.10-25	M10	25	36	20	23,0	8,0	112,0
P1043.10-30	M10	30	36	20	23,0	8,0	113,0
P1043.10-35	M10	35	36	20	23,0	8,0	117,0
P1043.10-40	M10	40	36	20	23,0	8,0	119,0