

Bearings - Thermoplastic, heavy duty

plain and flanged

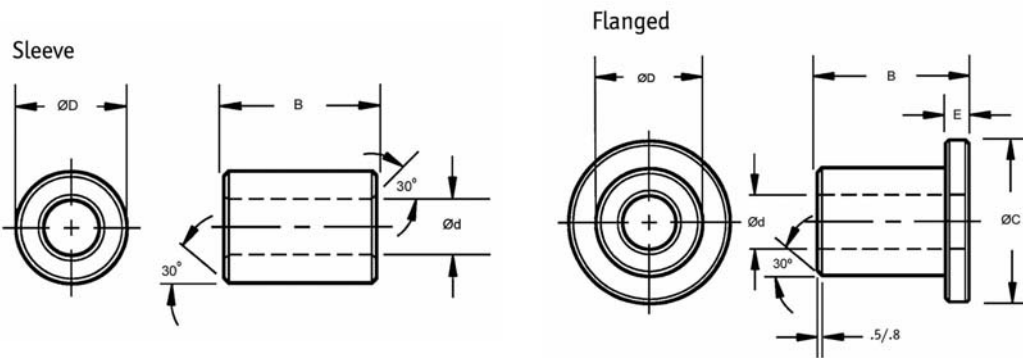

L1817



Material

Thermoplastic - see page XX for specification.

Technical Notes

Max. load 1529Kg/cm².

Order No. Flanged	Order No. Sleeve	Ød	ØD	ØC	B	E +0 -,14	i.d. ¹ max.	i.d. ¹ min.	Housing bore ¹ max.	Housing bore ¹ min.	Shaft Max	Shaft Min
B20M-1	B19M-1	4	5,5	9,5	4	0,75	4,058	4,010	5,512	5,500	4,000	3,970
B20M-2	B19M-2	5	7	11	5	1	5,058	5,010	7,015	7,000	5,000	4,970
B20M-3	B19M-3	6	8	12	8	1	6,058	6,010	8,015	8,000	6,000	5,970
B20M-4	B19M-4	8	10	15	9	1	8,071	8,013	10,015	10,000	8,000	7,964
B20M-5	B19M-5	10	12	18	6	1	10,071	10,013	12,018	12,000	10,000	9,964
B20M-6	B19M-6	10	12	18	9	1	10,071	10,013	12,018	12,000	10,000	9,964
B20M-7	B19M-7	12	14	20	9	1	12,086	12,016	14,018	14,000	12,000	11,957
B20M-8	B19M-8	12	14	20	12	1	12,086	12,016	14,018	14,000	12,000	11,957

