

Bearings - "Long-life"

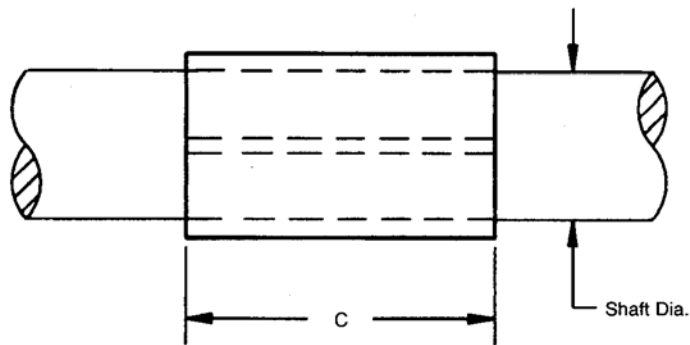

L1810



Material

Steel backed porous bronze with dry PTFE-Lead lubricating.

Technical Notes

Lasts up to 10 times longer than oil impregnated porous bronze bearings.

High loads.

Runs cool - excellent heat dissipation.

Operates in extreme temperatures.

Good for rotating, sliding and oscillating motions - both thrust and radial loads.

Temperature range -200°C to +280°C.

Max. continuous speed 5m/sec unlubricated, 10 m/sec lubricated.

Max. continual load 1,7 P.V.'s unlubricated, 70P.V.'s lubricated.

Compression strength $\pm 310\text{N/mm}^2$.

Order No.	Actual Shaft Size	Normal Shaft Size	Normal OD ØB	Housing Bore	Length C
L1810.03-03	3,000/2,994	3	4,5	4,508/4,500	3
L1810.03-06	3,000/2,994	3	4,5	4,508/4,500	6
L1810.05-05	4,991/4,979	5	7	7,016/7,001	5
L1810.05-08	4,991/4,979	5	7	7,016/7,001	8
L1810.05-10	4,991/4,979	5	7	7,016/7,001	10
L1810.06-06	5,992/5,980	6	8	8,017/8,002	6
L1810.06-10	5,992/5,980	6	8	8,017/8,002	10
L1810.08-08	7,993/7,978	8	10	10,021/10,006	8
L1810.08-12	7,993/7,978	8	10	10,021/10,006	12
L1810.10-08	9,992/9,977	10	12	12,023/12,005	8
L1810.10-12	9,992/9,977	10	12	12,023/12,005	12
L1810.10-20	9,992/9,977	10	12	12,023/12,005	20
L1810.12-08	11,991/11,973	12	14	14,025/14,007	8
L1810.12-12	11,991/11,973	12	14	14,025/14,007	12
L1810.12-25	11,991/11,973	12	14	14,025/14,007	25
L1810.16-12	15,984/15,966	16	18	18,018/18,00	12
L1810.16-15	15,984/15,966	16	18	18,018/18,00	15
L1810.16-25	15,984/15,966	16	18	18,018/18,00	25
L1810.20-15	19,992/19,971	20	23	23,033/23,012	15
L1810.20-20	19,992/19,971	20	23	23,033/23,012	20
L1810.20-30	19,992/19,971	20	23	23,033/23,012	30
L1810.25-15	24,993/24,972	25	28	28,034/28,013	15
L1810.25-25	24,993/24,972	25	28	28,034/28,013	25
L1810.25-50	24,993/24,972	25	28	28,034/28,013	50

