

## Ball bearings - flanged ABEC 7



# L1804



BEARINGS & SHAFTING

### Material

Stainless steel DIN 1,4112.

### Technical Notes

ABEC 7.

Unshielded - lubricated with oil.

Shielded - lubricated with grease.

### Tips

Lower ranges ABEC bearings available on request.

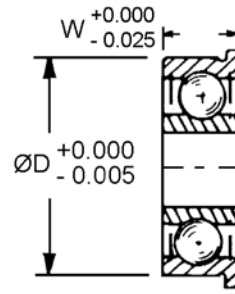
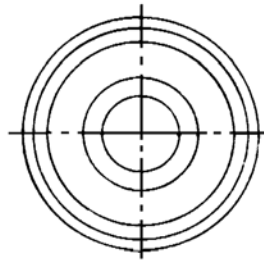

\*\*Shielded and Lubricated with grease

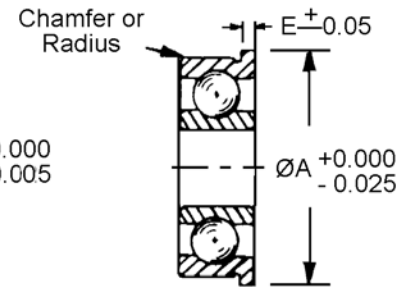

\*Unshielded and Lubricated with oil

| Order No. | Type       | Ød     | ØD     | W     | A      | E    | Max. Dynamic Loads (N) | Max. Static Load (N) |
|-----------|------------|--------|--------|-------|--------|------|------------------------|----------------------|
| B2-50     | Unshielded | 3,000  | 7,000  | 2,000 | 8,100  | 0,50 | 206                    | 108                  |
| B2-50-S   | Shielded   | 3,000  | 7,000  | 3,000 | 8,100  | 0,80 | 206                    | 108                  |
| B2-51     | Unshielded | 3,000  | 8,000  | 3,000 | 9,500  | 0,70 | 333                    | 196                  |
| B2-51-S   | Shielded   | 3,000  | 8,000  | 4,000 | 9,500  | 0,90 | 333                    | 196                  |
| B2-52     | Unshielded | 3,000  | 10,000 | 4,000 | 11,500 | 1,00 | 383                    | 216                  |
| B2-52-S   | Shielded   | 3,000  | 10,000 | 4,000 | 11,500 | 1,00 | 383                    | 216                  |
|           |            |        |        |       |        |      |                        |                      |
| B2-104-7  | Unshielded | 4,000  | 9,000  | 2,500 | 10,300 | 0,60 | 353                    | 196                  |
| B2-104-S7 | Shielded   | 4,000  | 9,000  | 4,000 | 10,300 | 1,00 | 353                    | 196                  |
|           |            |        |        |       |        |      |                        |                      |
| B2-53     | Unshielded | 5,000  | 11,000 | 3,000 | 12,500 | 0,80 | 392                    | 216                  |
| B2-53-S   | Shielded   | 5,000  | 11,000 | 5,000 | 12,500 | 1,00 | 392                    | 216                  |
| B2-54     | Unshielded | 5,000  | 13,000 | 4,000 | 15,000 | 1,00 | 451                    | 284                  |
| B2-54-S   | Shielded   | 5,000  | 13,000 | 4,000 | 15,000 | 1,00 | 451                    | 284                  |
| B2-55     | Unshielded | 5,000  | 16,000 | 5,000 | 18,000 | 1,00 | 1480                   | 746                  |
| B2-55-S   | Shielded   | 5,000  | 16,000 | 5,000 | 18,000 | 1,00 | 1480                   | 746                  |
|           |            |        |        |       |        |      |                        |                      |
| B2-106-7  | Unshielded | 6,000  | 13,000 | 3,500 | 15,000 | 1,00 | 579                    | 353                  |
| B2-106-S7 | Shielded   | 6,000  | 13,000 | 5,000 | 15,000 | 1,10 | 579                    | 353                  |
| B2-56     | Unshielded | 6,000  | 15,000 | 5,000 | 17,000 | 1,20 | 628                    | 402                  |
| B2-56-S   | Shielded   | 6,000  | 15,000 | 5,000 | 17,000 | 1,20 | 628                    | 402                  |
| B2-57     | Unshielded | 6,000  | 19,000 | 6,000 | 22,000 | 1,50 | 1890                   | 991                  |
| B2-57-S   | Shielded   | 6,000  | 19,000 | 6,000 | 22,000 | 1,50 | 1890                   | 991                  |
|           |            |        |        |       |        |      |                        |                      |
| B2-108-7  | Unshielded | 8,000  | 16,000 | 4,000 | 18,000 | 1,00 | 951                    | 628                  |
| B2-108-S7 | Shielded   | 8,000  | 16,000 | 6,000 | 18,000 | 1,30 | 951                    | 628                  |
|           |            |        |        |       |        |      |                        |                      |
| B2-58     | Unshielded | 10,000 | 19,000 | 5,000 | 21,000 | 1,50 | 1020                   | 696                  |
| B2-58-S   | Shielded   | 10,000 | 19,000 | 5,000 | 21,000 | 1,50 | 1020                   | 696                  |

