

# Hardened Hollow Shaft - steel

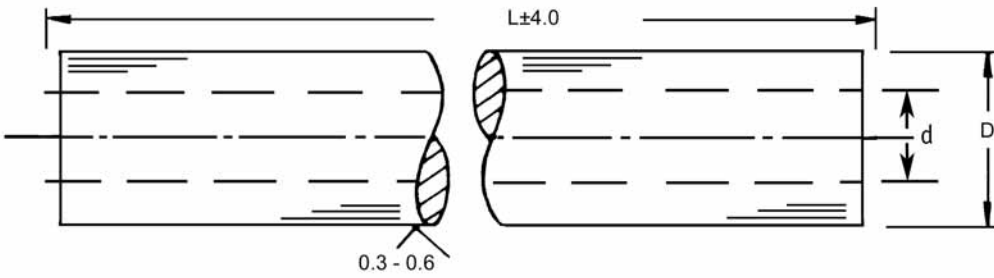

## L1771



| Order No. | Diameter<br>D | O.D. Ø<br>tol. µ | d<br>Ø | Depth of<br>Hardness<br>mm | Max.<br>Length<br>mm |
|-----------|---------------|------------------|--------|----------------------------|----------------------|
| HCS-12M-  | 12            | -11              | 4      | 1,6                        | 4000                 |
| HCS-16M-  | 16            | -11              | 7      | 1,6                        | 6000                 |
| HCS-20M-  | 20            | -13              | 14     | 2,2                        | 7500                 |
| HCS-25M-  | 25            | -13              | 15     | 2,2                        | 7500                 |
| HCS-30M-  | 30            | -13              | 18     | 2,2                        | 7500                 |
| HCS-40M-  | 40            | -16              | 28     | 3,5                        | 7500                 |
| HCS-50M-  | 50            | -16              | 28     | 3,5                        | 7500                 |

### Material

Carbon Steel C60, 61-66 HRC.

### Technical Notes

Used also in linear bearing and guideway systems.  
Tolerance, h6 standard, special tolerances upon request.

Finish, ground and polished to 8-12cla.

Straightness 1mm/6000mm standard.

Diameter tolerance 0,001mm.  
Ends not hardened.

### Tips

**Modifications, Drilled and tapped holes, retainer grooves, special coatings etc. available.**

### Important Notes

**Add length required (in mm.) after part number e.g.**

**HCS-12M-500 - 12mm hollow steel shaft 500mm long.**





# L1789



Material  
Aluminium.

Looking for  
imperial sizes?

We can supply  
many of our  
parts in imperial

## Shaft supports

Shaft supports

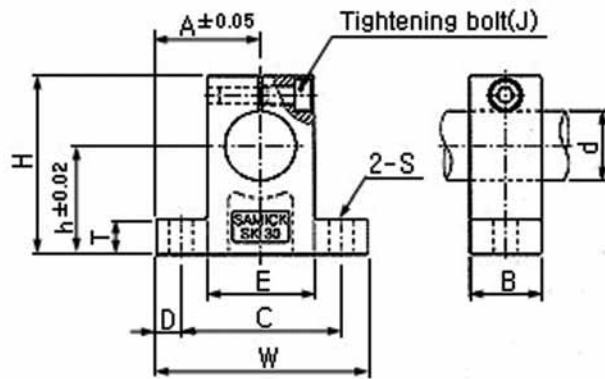

| Order No. | Shaft Dia. Ø | h  | A  | W   | H    | T  | E  | D   | C  | B  | S Ø | J  | $\frac{\Delta}{g}$ |
|-----------|--------------|----|----|-----|------|----|----|-----|----|----|-----|----|--------------------|
| SK8       | 8            | 20 | 21 | 42  | 32,8 | 6  | 18 | 5   | 32 | 14 | 5,5 | M4 | 24                 |
| SK10      | 10           | 20 | 21 | 42  | 32,8 | 6  | 18 | 5   | 32 | 14 | 5,5 | M4 | 24                 |
| SK12      | 12           | 23 | 21 | 42  | 38   | 6  | 20 | 5   | 32 | 14 | 5,5 | M4 | 30                 |
| SK13      | 13           | 23 | 21 | 42  | 38   | 6  | 20 | 5   | 32 | 14 | 5,5 | M4 | 30                 |
| SK16      | 16           | 27 | 24 | 48  | 44   | 8  | 25 | 5   | 38 | 16 | 5,5 | M4 | 40                 |
| SK20      | 20           | 31 | 30 | 60  | 51   | 10 | 30 | 7,5 | 45 | 20 | 6,6 | M5 | 70                 |
| SK25      | 25           | 35 | 35 | 70  | 60   | 12 | 38 | 7   | 56 | 24 | 6,6 | M6 | 130                |
| SK30      | 30           | 42 | 42 | 84  | 70   | 12 | 44 | 10  | 64 | 28 | 9   | M6 | 180                |
| SK35      | 35           | 50 | 49 | 98  | 85   | 15 | 50 | 12  | 74 | 32 | 11  | M8 | 270                |
| SK40      | 40           | 60 | 57 | 114 | 96   | 15 | 60 | 12  | 90 | 36 | 11  | M8 | 420                |



# Linear bushing carriage - closed

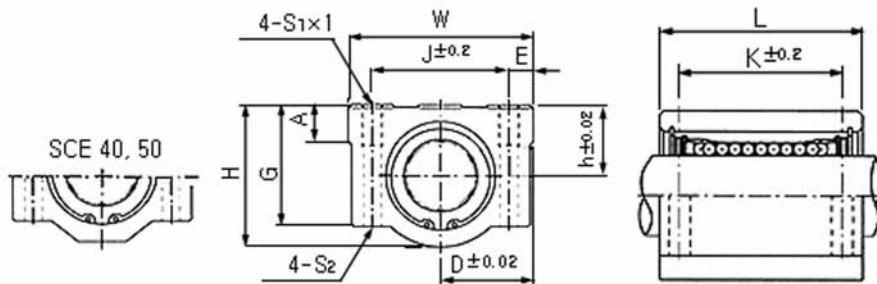

## L1750



**Material**  
Aluminium carriage, with linear bearing assembled.

| Order no. | Type     | Shaft Dia. Ø | h  | D  | W   | H    | G    | A  | J   | E   | S1x1   | S2 Ø | K   | L    | X <sub>g</sub> |
|-----------|----------|--------------|----|----|-----|------|------|----|-----|-----|--------|------|-----|------|----------------|
| SCE8      | Standard | 8            | 11 | 17 | 34  | 22   | 18   | 6  | 24  | 5   | M4x8   | 3,4  | 18  | 30   | 60             |
| SCE12     | Standard | 12           | 15 | 22 | 44  | 30   | 24,5 | 8  | 33  | 5,5 | M5x10  | 4,3  | 26  | 39   | 118            |
| SCE16     | Standard | 16           | 19 | 25 | 50  | 38,5 | 32,5 | 9  | 36  | 7   | M5x12  | 4,3  | 34  | 44   | 180            |
| SCE20     | Standard | 20           | 21 | 27 | 54  | 41   | 35   | 11 | 40  | 7   | M6x12  | 5,2  | 40  | 53   | 245            |
| SCE25     | Standard | 25           | 26 | 38 | 76  | 51,5 | 41   | 12 | 54  | 11  | M8x18  | 6,8  | 50  | 67   | 550            |
| SCE30     | Standard | 30           | 30 | 39 | 78  | 59,5 | 49   | 15 | 58  | 10  | M8x18  | 6,8  | 58  | 76   | 760            |
| SCE40     | Standard | 40           | 40 | 51 | 102 | 78   | 62   | 20 | 80  | 11  | M10x25 | 8,6  | 60  | 90   | 1700           |
| SCE50     | Standard | 50           | 52 | 61 | 122 | 102  | 80   | 24 | 100 | 11  | M10x25 | 8,6  | 80  | 110  | 2950           |
| SCE8W     | Long     | 8            | 11 | 17 | 34  | 22   | 18   | 6  | 24  | 5   | M4x8   | 3,4  | 42  | 58   | 98             |
| SCE12W    | Long     | 12           | 15 | 22 | 44  | 30   | 24,5 | 8  | 33  | 5,5 | M5x10  | 4,3  | 64  | 77   | 232            |
| SCE16W    | Long     | 16           | 19 | 25 | 50  | 38,5 | 32,5 | 9  | 36  | 7   | M5x12  | 4,3  | 79  | 89   | 360            |
| SCE20W    | Long     | 20           | 21 | 27 | 54  | 41   | 35   | 11 | 40  | 7   | M6x12  | 5,2  | 90  | 106  | 490            |
| SCE25W    | Long     | 25           | 26 | 38 | 76  | 51,5 | 41   | 12 | 54  | 11  | M8x18  | 6,8  | 119 | 136  | 1100           |
| SCE30W    | Long     | 30           | 30 | 39 | 78  | 59,5 | 49   | 15 | 58  | 10  | M8x18  | 6,8  | 132 | 154  | 1525           |
| SCE40W    | Long     | 40           | 40 | 51 | 102 | 78   | 62   | 20 | 80  | 11  | M10x25 | 8,6  | 150 | 180  | 3400           |
| SCE50W    | Long     | 50           | 52 | 61 | 122 | 102  | 80   | 24 | 100 | 11  | M10x25 | 8,6  | 200 | 230  | 5920           |
| SCE8V     | Short    | 8            | 11 | 17 | 34  | 22   | 18   | 6  | 24  | 5   | M4x8   | 3,4  | -   | 14,4 | 40             |
| SCE12V    | Short    | 12           | 15 | 22 | 44  | 30   | 24,5 | 8  | 33  | 5,5 | M5x10  | 4,3  | -   | 20,3 | 82             |
| SCE16V    | Short    | 16           | 19 | 25 | 50  | 38,5 | 32,5 | 9  | 36  | 7   | M5x12  | 4,3  | -   | 22,3 | 122            |
| SCE20V    | Short    | 20           | 21 | 27 | 54  | 41   | 35   | 11 | 40  | 7   | M6x12  | 5,2  | -   | 28,3 | 176            |
| SCE25V    | Short    | 25           | 26 | 38 | 76  | 51,5 | 41   | 12 | 54  | 11  | M8x18  | 6,8  | -   | 40,4 | 400            |
| SCE30V    | Short    | 30           | 30 | 39 | 78  | 59,5 | 49   | 15 | 58  | 10  | M8x18  | 6,8  | -   | 48,4 | 570            |
| SCE40V    | Short    | 40           | 40 | 51 | 102 | 78   | 62   | 20 | 80  | 11  | M10x25 | 8,6  | -   | 56,4 | 1320           |
| SCE50V    | Short    | 50           | 52 | 61 | 122 | 102  | 80   | 24 | 100 | 11  | M10x25 | 8,6  | -   | 72,3 | 1900           |



### L1750 - Load ratings

| Part No. | Installed | C(N) | Co(N) | Part No. | Installed | C(N) | Co(N) | Part No. | Installed | C(N) | Co(N) |
|----------|-----------|------|-------|----------|-----------|------|-------|----------|-----------|------|-------|
| SCE8     | LME8      | 260  | 400   | SCE8W    | 2xLME8    | 410  | 800   | SCE8V    | LME8      | 260  | 400   |
| SCE12    | LME12     | 410  | 590   | SCE12W   | 2xLME12   | 650  | 1180  | SCE12V   | LME12     | 410  | 590   |
| SCE16    | LME16     | 770  | 1170  | SCE16W   | 2xLME16   | 1230 | 2340  | SCE16V   | LME16     | 770  | 1170  |
| SCE20    | LME20     | 800  | 1370  | SCE20W   | 2xLME20   | 1370 | 240   | SCE20V   | LME20     | 800  | 1370  |
| SCE25    | LME25     | 980  | 1560  | SCE25W   | 2xLME25   | 1560 | 3120  | SCE25V   | LME25     | 980  | 1560  |
| SCE30    | LME30     | 1560 | 2740  | SCE30W   | 2xLME30   | 2490 | 5480  | SCE30V   | LME30     | 1560 | 2740  |
| SCE40    | LME40     | 2150 | 4010  | SCE40W   | 2xLME40   | 3440 | 8020  | SCE40V   | LME40     | 2150 | 4010  |
| SCE50    | LME50     | 3820 | 7930  | SCE50W   | 2xLME50   | 6110 | 15860 | SCE50V   | LME50     | 3820 | 7930  |

